

Software version TC4.1
February 2011

EX90

User guide



What's in this guide?

The top menu bar and the entries in the Table of Contents are all hyperlinks. Just click on them to go to the topic.

We recommend that you visit the Cisco web site regularly for updated versions of this guide. Go to: <http://www.cisco.com>

Introduction

Introduction	4
--------------------	---

Connecting the EX90

Rear sockets access	7
The EX90 parts	7
Connecting	7
Connecting for use as PC screen	7
Connecting a PC to the unit	8
Use as PC screen	8
Setting the screen resolution	8
Using an external monitor to show presentations ..	8

Using the EX90

Camera adjustments	10
Use as document camera	10
Touch controller—initial view	11
Initial settings—before you begin	12
Calling someone by dialing the number or URI ...	13
Searching for an entry in any of the lists	14
Calling an entry in any of the lists	15
Two calls at the same time	16
Transferring calls	17
Calling more than one	18
Adding participants to an ongoing call	19
Layout control in MultiSite	20
Favorites	21
Searching	21
Directory	21
History	21
Do not disturb	22
Using Touch Tones (DTMF)	22
Far end camera control	22
Sharing contents—conducting presentations	23

The Settings using Touch

Setting the EX90 in standby	25
Shutting down the EX90	25
Reverting to factory default settings	25
Gaining access to the Settings	26
System Information	27
Call settings	27
Call Status	28
Camera Control and Settings	29
Display Settings	30
Ringtone & Sound Settings	31
Background	32
Administrator Settings—Date, Time & Location ...	33
Administrator Settings—Call Settings	34
Administrator Settings—IP Settings	35
Administrator Settings—H.323 Settings	36
Administrator Settings—SIP Settings	37
Administrator Settings—Provisioning	38
Administrator Settings—EMC Resilience Mode	39

The web interface

Entering the web interface	41
----------------------------------	----



Chapter 1

Introduction

Introduction

The objective of this documentation is to provide the reader with assistance in using and configuring the product. The specifications for the product and the information in this Guide are subject to change at any time, without notice, by Cisco/TANDBERG. Every effort has been made to supply complete and accurate information in this Guide; however, Cisco/TANDBERG assumes no responsibility or liability for any errors or inaccuracies that may appear in this document.

TANDBERG® is a registered trademark belonging to Tandberg ASA. Other trademarks used in this document are the property of their respective holders.

This Guide may be reproduced in its entirety, including all copyright and intellectual property notices, in limited quantities in connection with the use of this product. Except for the limited exception set forth in the previous sentence, no part of this Guide may be reproduced, stored in a retrieval system, or transmitted, in any form, or by any means, electronically, mechanically, by photocopying, or otherwise, without the prior written permission of Cisco/TANDBERG.

www.tandberg.com

TANDBERG is now part of Cisco

© 2010–2011 TANDBERG

This unit makes use of photos provided by Fotolia. These photos are Copyright © Fotolia. The following photographers have contributed:

Anette Linnea Rasmussen
Alex Bramwell
Stephen Coburn
Eric Gevaert
Stephen Coburn
Stocksnapper
Yurok Aleksandrovich
ordus
Sven Taubert
Bas Meelker
Paylessimages
Vilnis

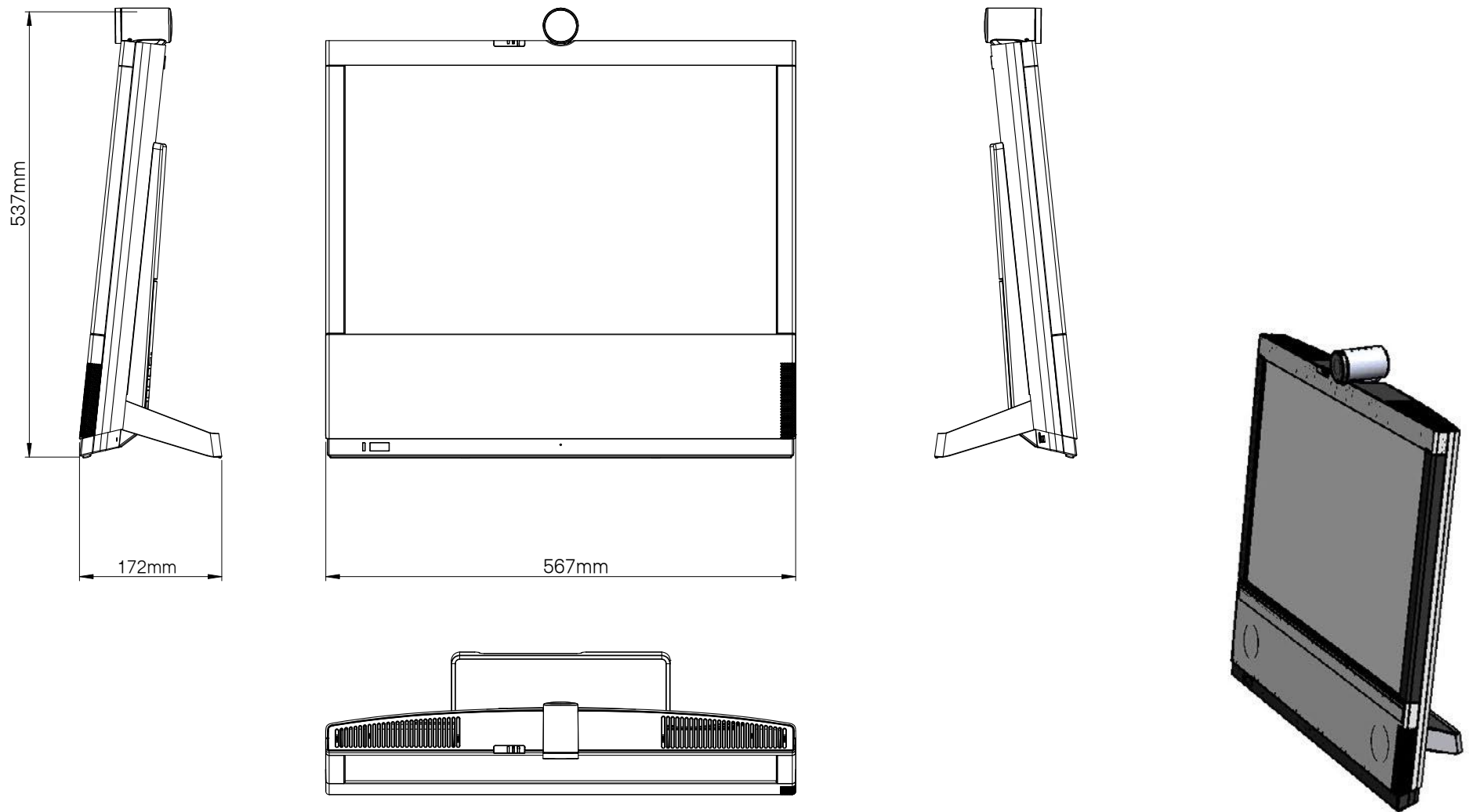



Chapter 2

Connecting the EX90

Connecting the EX90

Connect the cables as shown. Sockets are located behind the rear cover. If you have one LAN connection only—and need that for your PC—the EX90 has a built in Gigabit ethernet switch that enables you to connect your PC to the EX90 to access the LAN through the EX90.

Rear sockets access

Remove cover to get access to the connector sockets.

The cover is vented in the lower left corner (external view) due to the rear mounted loudspeaker.

When mounting the cover back on, make sure the vents are where the speaker is (as shown).

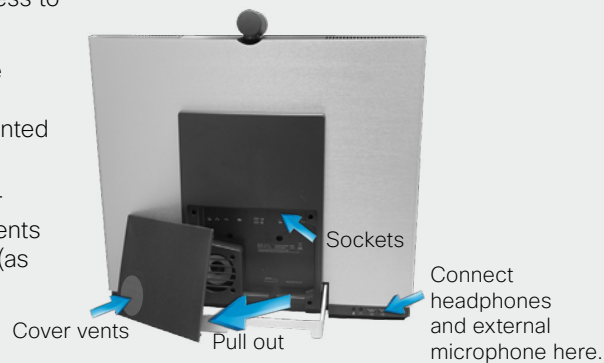

The EX90 parts

Camera with built-in privacy shutter.



The Cisco TelePresence touch screen controller



Connecting



- 1 Connect your PC here if you need to share a single LAN connection with the EX90.
- 2 Connect your EX90 to the LAN.
- 3 USB socket (for future use).
- 4 Connect the touch screen controller.
- 5 HDMI In (inner socket) and HDMI Out* (outer socket).
- 6 Connect power here.

* HDMI out is used when connecting an extra monitor (typically for presentations)—see the next page for more.

Connecting for use as PC screen

Your EX90 has an HD display, which also may serve as your PC screen.

Connect your PC to the sockets on the rear panel as shown below.

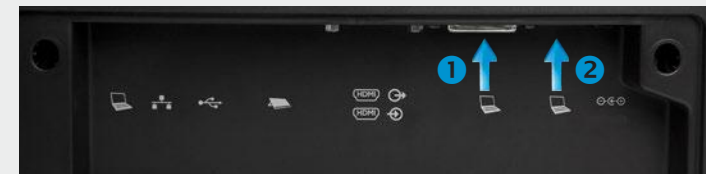

Connect your PC video to 1 and PC audio to 2

A resolution of 1920 × 1200 is recommended. For a list of other screen resolutions supported, see “Setting the screen resolution” on page 9.

Connecting a PC to the unit

Your EX90 has an HD display, which also may serve as your PC screen. Connect your PC to the sockets on the rear panel as shown below. For optimal PC image quality, digital output (DVI) from the PC is recommended. If both DVI and HDMI are connected, a **Source** button appears in the setup menu on the touch screen to let you select which source to use as PC screen.



Connect your PC video to ① and PC audio to ②

Use as PC screen

Your EX90 has an HD display, which also may serve as your PC screen. Connect your PC to the sockets on the rear panel as shown above.

Your EX90 will serve as your PC screen outside calls. In a call tap **Presentation** to view your desktop. Your desktop is not exposed to the other side before you press **Present**.

Setting the screen resolution

A resolution of 1920 × 1200 is recommended. However, other resolutions may also be used as shown in the below tables.

Digital input via DVI

1920 × 1200 (recommended)
1920 × 1080
1776 × 1000 (not full screen)
1680 × 1050
1600 × 1200 (not full screen)
1440 × 900
1400 × 1050 (not full screen)
1280 × 1024 (not full screen)
1280 × 960 (not full screen)
1280 × 800
1280 × 768 (not full screen)
1280 × 720 (not full screen)
1152 × 648 (not full screen)
1024 × 768 (not full screen)
960 × 600 (not full screen)
800 × 600 (not full screen)

Analog input via DVI

1920 × 1200 (recommended)

1680 × 1050
1600 × 1200 (not full screen)
1440 × 900

1280 × 1024 (not full screen)

1024 × 768 (not full screen)
800 × 600 (not full screen)

Screen resolution must be set via the web interface, using the **Video Output HDMI [1] Resolution** setting. For details on this, see the EX90 Administrator Guide, which is available separately for download.

Using an external monitor to show presentations

You may connect an external monitor to your EX90 to have it work with two monitors at the same time. The second monitor can be configured to show presentations instead of having everything on a single screen.

To enable the use of a second monitor the system must be configured for it. This is done via the web interface using the **Video DefaultPresentationSource** setting. Doing so is described in the EX90 Administrator Guide which is available separately for download .



Chapter 3

Using the EX90

Camera adjustments

The camera can be tilted mechanically in vertical direction.



Turn the circumference to activate the privacy shutter.



Use as document camera

Tilt the camera as shown to use it as a document camera. Image is automatically turned upside down, so that both parties will see the document correctly.

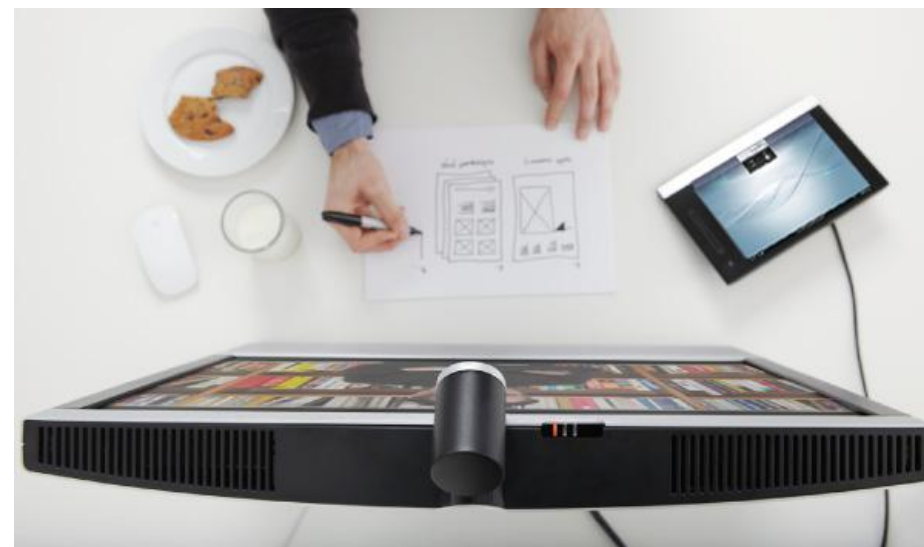

Touch controller—initial view



Initial settings—before you begin

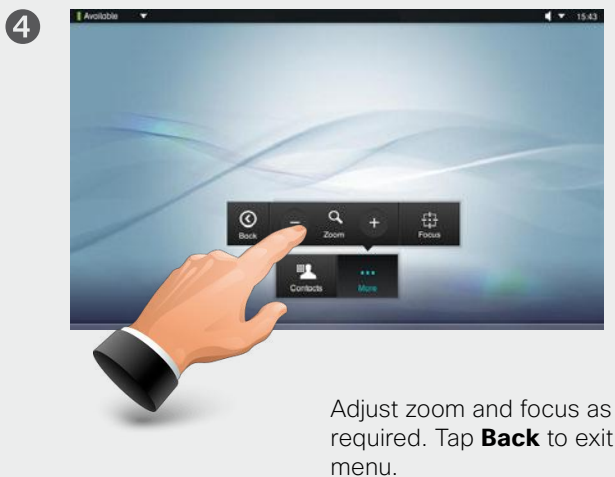

Calling someone by dialing the number or URI

1



Tap **Contacts** as outlined, if needed ...

2



... then tap **Search or Dial**.



If you need to key in digits or special characters, press and hold the key until the character appears.

3



Tap the **CALL** button to place the call.

4

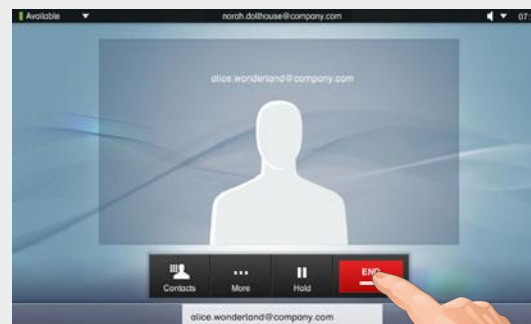

Terminate the call by tapping **END**.

Searching for an entry in any of the lists



Tap **Contacts** as outlined, if needed ...



... then tap **Search or Dial**.



Enter the name, parts of the URI or parts of the number. Matches will appear as you write. Searching will take place within **Favorites**, **Directory** as well as **History** (see the next page for more on these).



Scroll among the matches, if needed ...

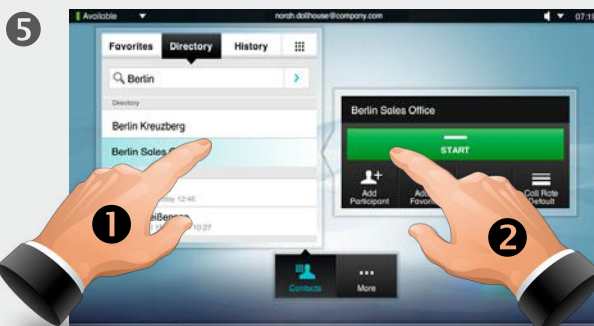

... then tap the entry to be called (1) and finally tap **START** (2) to place the call.

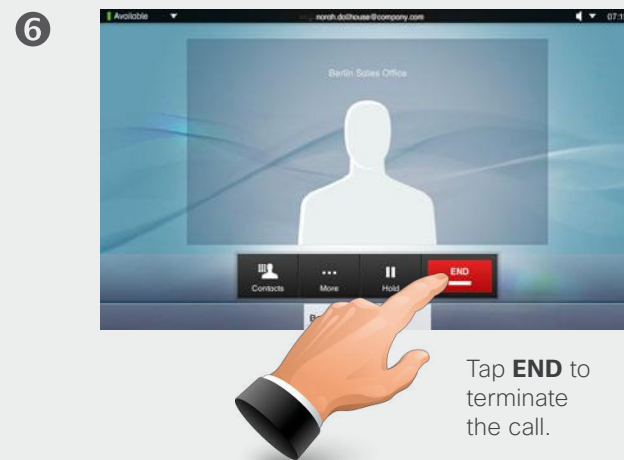

Tap **END** to terminate the call.

Calling an entry in any of the lists

1



Tap **Contacts** as outlined, if needed ...

2



... then tap **Favorites, Directory, or History**.

3



Scroll among the entries, if needed ...

4



... then tap the entry to be called (1) and finally tap **START** (2) to place the call.

5

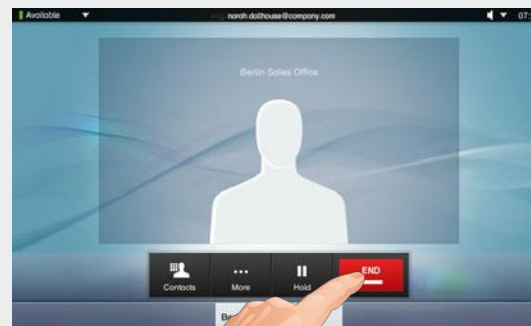

Tap **END** to terminate the call.

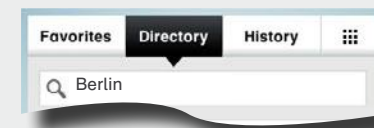

Favorites. The list of favorites is your own shortlist of people and places you frequently call or otherwise want to have easy access to.

Directory. The directory serves as your corporate phone book. This directory cannot be edited by you. You may, however, copy entries to your list of favorites and edit them there.

History lists the received, placed and missed calls since the last time the list was cleared.

Keypad. Tap the keypad icon  to produce the keypad to enter a number or URI.

Two calls at the same time



In a call tap **Hold** to put the current call on hold ...



... then tap **Favorites, Directory, or History** ...



... then tap the entry to be called (1) and finally tap **START** (2) to place the call.



You will now be in a call with the second person, while the first one is on hold. In this example, you talk to **Peer Gynt**, while **Berlin Sales Office** is on hold.

5 Click on the person currently on hold (here **Berlin Sales Office**) to be offered swapping of the calls or transferring the call on hold to someone else.

Optional feature:

If you drag **Berlin Sales Office** from the bottom line and onto the stage, you will initiate a MultiSite call (a video conference) with **yourself, Berlin Sales Office** and **Peer Gynt**.

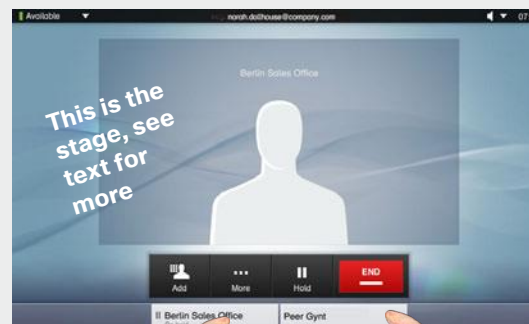

Transfer is available to SIP calls only and the procedure is shown on the next page.

If your EX90 is equipped with the optional MultiSite feature you may also set up a video conference with three participants and yourself. See "Calling more than one" on page 18.

Click on the person you currently talk to (here **Peer Gynt**) to terminate or transfer that call.

Transferring calls

1



In a SIP call tap the name along the bottom line of the screen.

2



... then tap **Transfer**...

3

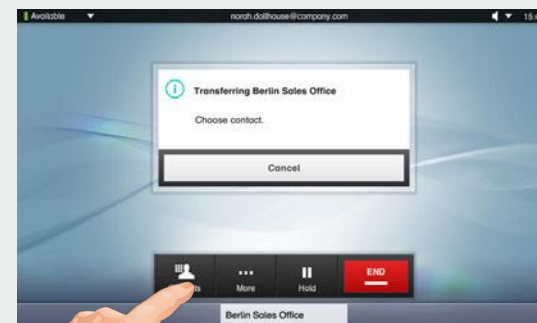

Now, tap **Contacts** to gain access to the call lists and dial field.

4



Call the person to whom the current call shall be transferred. When you tap the green call button (not shown), the call will be transferred.

5

The call will now be transferred. This will work irrespective of who initiated the call.

Note that you may combine **Transfer** with the **Hold** and **Swap** features as much as you want.

This means, for example, that in a call you may:

- Put your current call on hold and call a second party.
- Then initiate a transfer of the one on hold to the second party.
- You may now disengage yourself by tapping **END** on your unit.

Calling more than one

- 1 Calling several to initiate a video conference is an optional feature. If your system permits it, you may define two participants and then call them both in one go.

Enter a number or URI, or pick an entry from the **Directory**, the list of **Favorites**, or from the **History**.

- 2



Tap **ADD PARTICIPANT** as outlined to create a list of participants to be called.

- 3

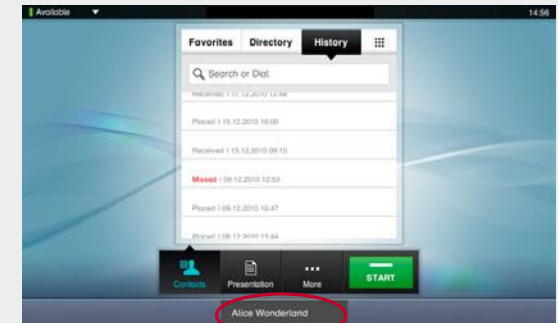

The entry will appear on the bottom line of the touch pad, as outlined.

- 4



Repeat the procedure to add a second participant.

- 5



When both have been added, tap **START** to call them all.

- 6



Tap **END** to terminate the entire conference. To disconnect just one of the participants, tap the participant's name along the bottom line and then tap **END**.

Adding participants to an ongoing call



While in a call you may add another participant, provided that your system permits to do so. Tap **Add** ...



... then select, in the usual way, whom to add to the ongoing call.



Once you have selected someone, the **ADD TO MEETING** dialog box will be produced ...



... now, tap **ADD TO MEETING** to include this participant in the meeting.



Tap **END** to terminate the entire conference. To disconnect just one of the participants, tap the participant's name along the bottom line and then tap **END**.

Layout control in MultiSite

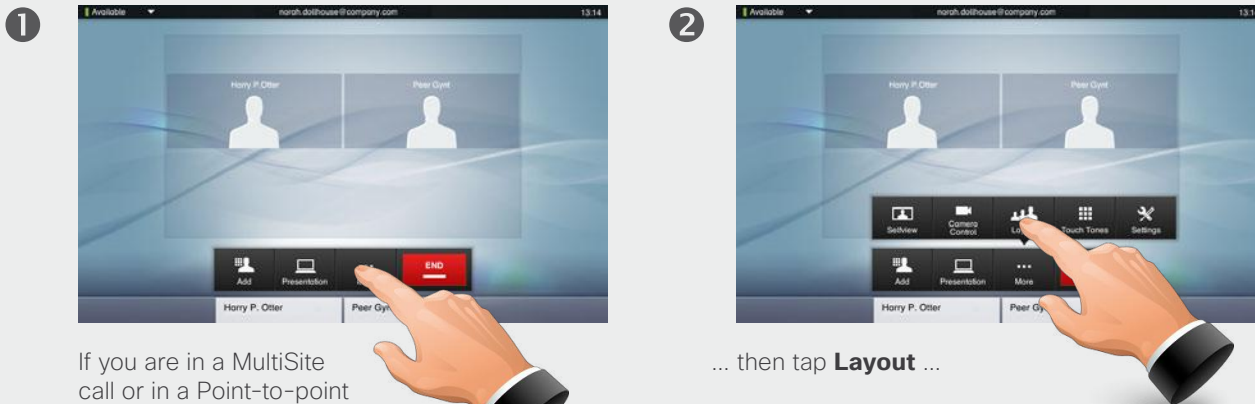

If you are in a MultiSite call or in a Point-to-point call with a presentation, you may alter the layout on the screen. To do this start by tapping **More** ...



...

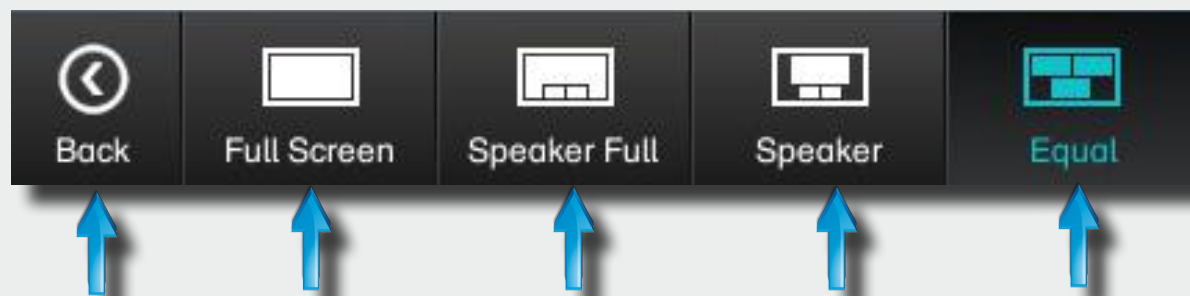

Takes you one menu level back

The one who speaks get the full screen. Nothing else is shown.

The one who speaks gets the main frame. The others are shown as PiP (Picture in Picture).

The one who speaks gets the main frame. The others are shown as images below the main frame.

All participants are shown in frames of identical sizes.

When a presentation is included in a call, all participants will be shown **above** the presentation instead of below. This will provide a better feeling of eye contact. Full screen will show the presentation only.

History

History lists the received, placed and missed calls since the last time the list was cleared.

Tap **History** to produce the list ...



... then tap an entry.



You will now be able to:

- Call the entry by tapping **Start**.
- Add the entry to an ongoing call (optional feature).
- Add the entry to **Favorites**.
- Edit the entry information and then place the call.
- Change the call rate settings.
- Remove the entry from the list.
- Clear the entire list. To do this, scroll as outlined beyond what appears to be the top of the list. A **Clear List** button will then appear.

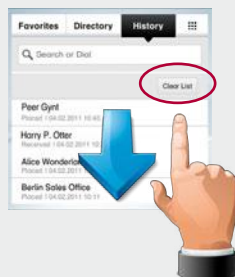

Directory

The **Directory** serves as your corporate phone book. This directory cannot be edited by you. You may, however, copy entries to your list of favorites and edit them there.

Tap **Contacts** (if needed) and then tap **Directory**. The directory is typically organized as folders.



Tap a folder (1) to show its contents, scroll (2) if needed to locate a folder or an entry within a folder.

Once located, tap the entry to call, edit or add to your list of favorites in the same way as with the history list.

It may happen that an entry copied from the directory to the list of favorites later is updated in the directory. This update will not be reflected in your list of favorites—you must then manually update the entry in the list of favorites.

Favorites

Favorites is your own shortlist of contacts you frequently call or otherwise want to have easy access to.

Adding to Favorites. To add someone to the list of favorites, locate the entry in **Directory** or **History** (as outlined) and tap it (1). This will produce a dialog box which allows you to tap **Add to Favorites** (2).



You may now edit the entry, if needed—just tap a field and the keyboard will be produced. Tap **Save** to put changes into effect..



Favorites should be considered as an editable directory and is used in the same way as **History**.

Searching

You may search for entries (numbers or URIs). Searches will be conducted within all the folders, i.e. within the **Favorites**, the **Directory** and the **History**.

Tap in the **Search or Dial** field and key in the name, URI or number. Matches will appear as you search.

Once located, tap the entry to call, edit or add to **Favorites**.



When searching within the corporate **Directory**, the search will apply to the current directory folder and its subfolders only. To go one level up, tap **Back**. To make the search apply to the entire corporate directory, do not enter (tap) any folder before the search is commenced.

Do not disturb

When set to **Do Not Disturb** (DND), ringtones are muted and missed calls you get while having DND active, will be presented when you exit DND..

You may, however, place calls as much as you like. To activate this feature, press the icon in the upper left corner. Press again to deactivate.

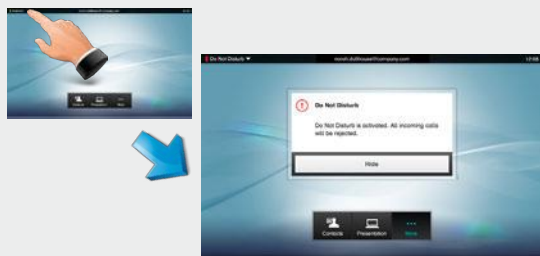

You may also hide the Do Not Disturb poster by tapping **Hide**.

Using Touch Tones (DTMF)

Sometimes you may be urged to enter touch tones (DTMF) during a call, typically to reach extensions or to provide a pin code.



In a call, tap **More** (1) followed by **Touch Tones** (2).

Use the touch tone keypad. Tap anywhere outside it to exit.



Far end camera control

If the other end point permits it, you may control their camera. This is known as **Far end camera control**.

If the other camera cannot be controlled, nothing happens.

This works in Point-to-point calls as well as MultiSite calls.

This works in Point-to-point calls as well as MultiSite calls.



Tap the name, whose camera shall be controlled, along the bottom line (1) and then tap **Camera Control** (2).



Adjust zoom and pan as required. Tap **Back** to exit the menu

Sharing contents—conducting presentations

1

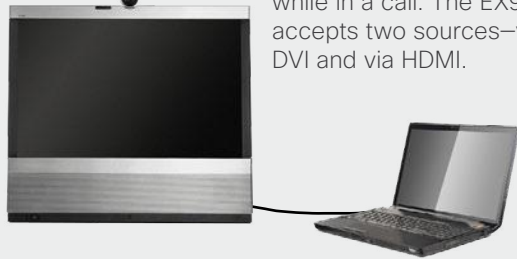

You may share contents while in a call. The EX90 accepts two sources—via DVI and via HDMI.

Note! You must be in a call to be able to share contents. Your presentation source must be powered and active as well as connected. Otherwise the **Presentation** icon (button) will fail to appear.

2



Once you are in a call—and the presentation source is connected, powered and active—the **Presentation** icon (button) will appear.

In a call tap **Presentation** ...

3



... then tap **PRESENT** to start sharing contents.

4



Tap **STOP PRESENTING** to stop sharing contents.

If you have two sources connected, you will be presented with the possibility to swap between these at any time.



The EX90 can be configured via the touch screen controller or via its web interface. For full access to all configurable parameters the web interface must be used—the touch screen controller provides access to a limited set of parameters only.

Chapter 4

The Settings using Touch

Setting the EX90 in standby

Outside a call, you may have the unit enter standby mode by touching the **Power** button on the main unit (the screen). The *Standby* dialog is displayed and the unit enters standby immediately. This does not work when you are in a call.

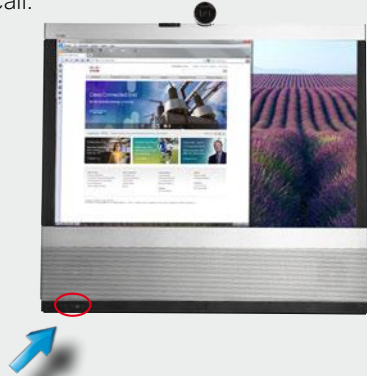

Tap as shown to wake up the system from standby.

Reverting to factory default settings

To revert to the factory default settings, do as follows:

1. Disconnect the power cord.
2. Reconnect the power cord—a green light will illuminate shortly after.
3. Press the **Power** button as soon as the green light appears. Keep it depressed for 15 seconds or so, until the green light starts flashing.
4. Release the button and press twice within 2 seconds. All settings will now revert to factory default settings.

Shutting down the EX90

Outside a call, press the **Power** button until the *Shutdown progress bar* is filled completely.

Release the button and the unit will go in shutdown in just a few seconds.

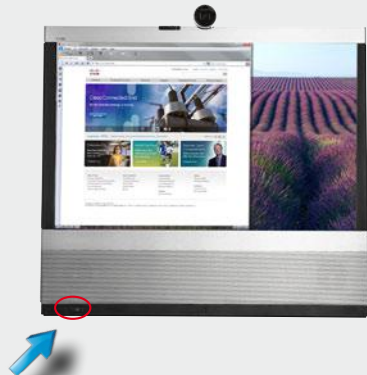

To start the system again, press the **Power** button until the LED illuminates (green light).

Gaining access to the Settings

Access the Settings as follows:

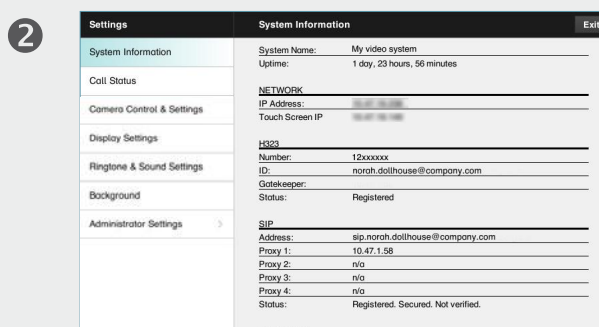

... and then you get access to the settings available. Observe that there are several other settings available, but these can be accessed from the web interface only. See the Administrator guide for your Cisco product. This guide is available for download separately.

System Information

The System information provides all the system information at a glance.

Scroll down to also see status on video inputs (DVI and HDMI).

Settings	System Information Exit
System Information	<p>System Name: My video system</p> <p>Uptime: 1 day, 23 hours, 56 minutes</p>
Call Status	
Camera Control & Settings	<p>NETWORK</p> <p>IP Address: 10.47.1.58</p> <p>Touch Screen IP: 10.47.1.58</p>
Display Settings	<p>H323</p> <p>Number: 12xxxxxx</p> <p>ID: norah.dollhouse@company.com</p> <p>Gatekeeper:</p> <p>Status: Registered</p>
Ringtone & Sound Settings	
Background	
Administrator Settings >	<p>SIP</p> <p>Address: sip.norah.dollhouse@company.com</p> <p>Proxy 1: 10.47.1.58</p> <p>Proxy 2: n/a</p> <p>Proxy 3: n/a</p> <p>Proxy 4: n/a</p> <p>Status: Registered. Secured. Not verified.</p>
	<p>SOFTWARE</p>

Call Status

The **Call Status** pane provides in-call information on such things as call rate and frame rate, protocols used, packet loss and jitter.

Settings	Call Status	Exit
System Information	Remote URI: peer.gynt@himself.enough.no	
Call Status	Call Rate: 768 Encryption Type: None	
	Protocol: sip Encryption Off	
Camera Control & Settings	VIDEO	
	Transmit	Presentation Receive Presentation
	Protocol: H264	Off H264 Off
Display Settings	Resolution: 768x448	n/a 768x448 n/a
	Frame Rate: 30	n/a 29 n/a
Ringtone & Sound Settings	Channel Rate: 704 kbps	n/a 664 kbps n/a
	Total Packet Loss	0.0% 0.0%
	Current Packet Loss	0.0% 0.0%
Background	Jitter: 1 ms	2 ms
Administrator Settings	AUDIO	
	Transmit	Receive
	Protocol: AACLD - Mono	AACLD - Mono
	Channel Rate: 63 kbps	63 kbps
	Total Packet Loss	0.0% 0.0%
	Current Packet Loss	0.0% 0.0%
	Jitter: 2 ms	0 ms

Camera Control and Settings

The **Camera Control & Settings** pane lets you set the whitebalance and exposure of the camera. If you do not want to tweak this yourself, just leave it to the system by selecting **Auto**.

Backlight compensation comes in handy when there is much light behind you. Without compensation you will easily appear very dark to the far end.

Note how the settings chosen are indicated. In the example shown, Backlight compensation is set to Off.

Settings	Camera Control & Settings	Exit
System Information	Whitebalance <div> <input type="button" value="Auto"/> <input type="button" value="Manual"/> </div>	
Call Status	Whitebalance (1) <div> <input type="text" value="1"/> <input type="range" value="16"/> <input type="text" value="16"/> </div>	
Camera Control & Settings	Exposure <div> <input type="button" value="Auto"/> <input type="button" value="Manual"/> </div>	
Display Settings	Exposure (1) <div> <input type="text" value="1"/> <input type="range" value="31"/> <input type="text" value="31"/> </div>	
Ringtone & Sound Settings	Backlight compensation <div> <input type="button" value="OFF"/> <input type="button" value="ON"/> </div>	
Background		
Administrator Settings >		





Display Settings

The **Display settings** let you adjust:

Preferred brightness by moving the *Brightness* slider.

The color balance. There are four preset color settings (Cold, Neutral, Warm and your own (Custom)) available. When you select Custom, you may use the Red, Green and Blue sliders to specify your own setting.

The DVI mode can be set to automatically detect the type of video signal received, or forced to analog or digital. The DVI mode is used when the unit is connected to a PC to serve as a PC monitor.

Settings	Display Settings	Exit
System Information	Brightness (50) 0  100	
Call Status	Colors Cold Neutral Warm Custom	
Camera Control & Settings	Red (50) 0  100	
Display Settings	Green (50) 0  100	
Ringtone & Sound Settings	Blue (50) 0  100	
Background	DVI Mode Auto Digital Analog	
Administrator Settings >		

Ringtone & Sound Settings

The **Ringtone & Sound Settings** pane lets you specify:

Keytones on or off. When set to on you will hear a sound every time you tap a field on the Touch controller.

Ringtone volume. How loud your ringtone shall sound.

Ringtone. Select among several ringtones. You will hear a sample every time you tap a ringtone.

Note how the settings chosen are indicated. In the example shown, Keytones are set to Off.

Settings	Ringtone & Sound Settings Exit
System Information	Keytones OFF ON
Call Status	Ringtone volume (50) 0 100
Camera Control & Settings	Ringtone <div> <input checked="" type="radio"/> Marbles <input type="radio"/> IceCrystals <input type="radio"/> Polaris </div> <div> <input type="radio"/> Alert <input type="radio"/> Discreet <input type="radio"/> Fantasy </div> <div> <input type="radio"/> Jazz <input type="radio"/> Nordic <input type="radio"/> Echo </div> <div> <input type="radio"/> Rhythmic </div>
Display Settings	
Ringtone & Sound Settings	
Background	
Administrator Settings >	

Background

The background image on the touch screen controller can be changed.

Tap one of the small images to use it as background image.

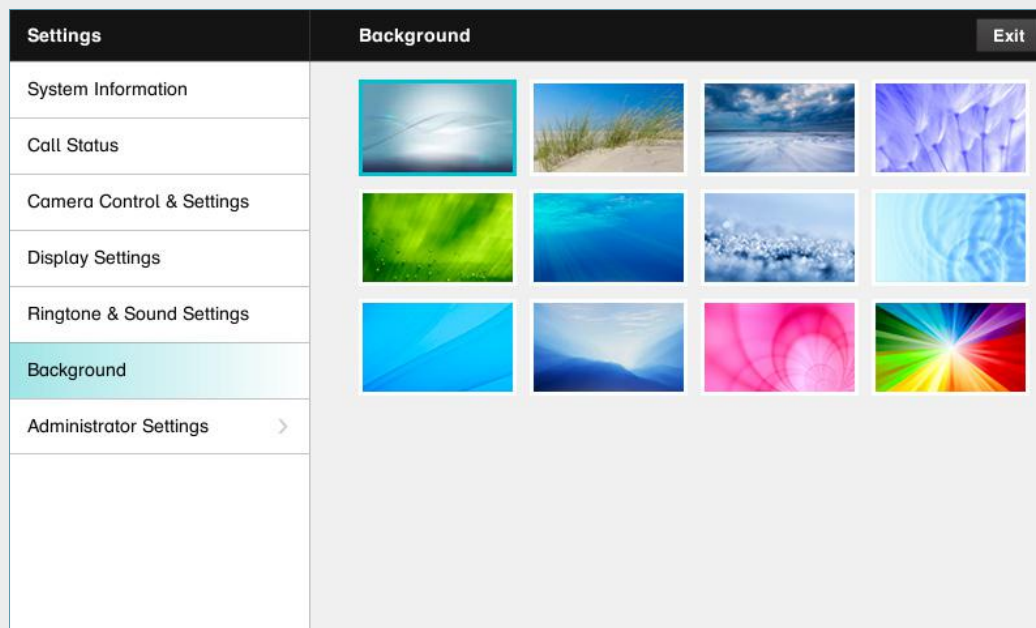

Administrator Settings—Date, Time & Location

The **Date, Time & Location** settings let you specify:

- 24h or 12h time format.
- Your preferred date format.
- Your preferred time zone.
- Whether date and time shall be set automatically or manually.

Note how the settings chosen are indicated. In the example shown, Time format is set to 24h.

Settings	Administrator ...	Date, Time & Location	Exit
Date, Time & Location		Time format <div>24h 12h</div>	
Call Settings		Date format <div>dd.mm.yy mm.dd.yy yy.mm.dd</div>	
IP Settings		Time zone <div>- GMT+01:00 (Amsterdam, Berlin, Bern, R +</div>	
H323 Settings		Date and time <div>Auto Manual</div>	
SIP Settings		<div>Hour Minute Year Month Day</div> <div> <div>+ + + + +</div> <div>13 11 2011 Jan 31</div> <div>- - - - -</div> </div>	
Provisioning			
EMC Resilience Mode			

Administrator Settings—Call Settings

The **Call Settings** pane lets you specify:

- **Auto Answer** On or Off. If you set this to **On**, the system will respond automatically to incoming calls. Note that the microphone will NOT be muted. If risk of eavesdropping is an issue, you may want to set this setting to **Off**.
- **Auto Answer Delay**. Specify the time until your system actually responds to an incoming call.
- **Default Call Rate**. If your connection has limited capacity you may want to use this setting.
- **Max Incoming/Outgoing Bandwidth**. You may specify these separately. May come in handy if you are on an asymmetric connection.
- **Default Call Protocol**. Specify which protocol to use as default.

Note how the settings chosen are indicated. In the example shown, Auto Answer is set to Off.

Settings	Administrator ...	Call Settings	Exit
Date, Time & Location		Auto Answer <div> <div>OFF</div> <div>ON</div> </div>	
Call Settings		Auto Answer Delay <div> <div>-</div> <div>0s</div> <div>+</div> </div>	
IP Settings			
H323 Settings		Call Rate	
SIP Settings		Default Call Rate (768) <div> <div>-</div> <div>768</div> <div>+</div> </div>	
Provisioning		Max Incoming Bandwidth (6000) <div> <div>-</div> <div>6000</div> <div>+</div> </div>	
EMC Resilience Mode		Max Outgoing Bandwidth (6000) <div> <div>-</div> <div>6000</div> <div>+</div> </div>	
		Default Call Protocol (Sip) <div> <div>H323</div> <div>Sip</div> </div>	

Administrator Settings—IP Settings

The **IP settings** pane lets you specify:

- The use of **DHCP** or **Static** IP addresses. If you decide to use **Static**, make sure you tap **Save** before leaving the menu.

SettingsAdministrator ...

IP SettingsExit

Date, Time & Location

Call Settings

IP Settings

H323 Settings

SIP Settings

Provisioning

EMC Resilience Mode

IP assignment

DHCPStatic

IP address10.47.19.219

Subnet mask255.255.255.0

Gateway10.47.19.1

Save

Administrator Settings—H.323 Settings

The **H.323 Settings** pane lets you specify:

- An **H.323 alias**.
- Your **H.323 id**.
- **Gatekeeper discovery** (**Manual** or **Automatic**).
- The **Gatekeeper address** must be specified by you if discovery has been set to manual.
- **Authentication mode** **On** or **Off**. If set to **On**, the video system will send **Login name** and Password to the Gatekeeper for authentication.

In addition there are:

- Two fields to enter **Login name** and **Password**. The alphanumeric keyboard will appear whenever needed.

Be sure to:

- Tap **Save** to put changes into effect.

Settings	Administrator ...	H323 Settings	Exit
Date, Time & Location	H323 number	559171	
Call Settings	H323 id	peer.gynt@himself.enough.com	
IP Settings	Gatekeeper discovery	<input checked="" type="radio"/> Auto <input type="radio"/> Manual	
H323 Settings	Gatekeeper address	10.47.1.58	
SIP Settings	Authentication mode	<input type="radio"/> OFF <input checked="" type="radio"/> ON	
Provisioning	Login name		
EMC Resilience Mode	Password		
			Save

Administrator Settings—SIP Settings

The **SIP settings** pane lets you specify:

- Your **URI**.
- The **Default transport layer**, this can be set to **TCP**, **UDP**, **TLS** or **Auto**.
- The **Proxy type** can be set to **Standard**, **Alcatel**, **Avaya**, **Cisco**, **Microsoft**, **Nortel**, **Experimental**, **Siemens**.
The experimental setting is for testing purposes.
- **Outbound** is not used in this version.
- **Proxy discovery** can automatic or manual. In the case of manual the proxy address must be specified by you.
- **Login name** and **Password** is required by the VCS.

Be sure to:

- Tap **Save** to put settings into effect.

Settings	Administrator ...	SIP Settings	Exit
Date, Time & Location	URI	sip:peer.gynt@himself.enough.com	
Call Settings	Default transport	<input checked="" type="radio"/> TCP <input type="radio"/> UDP <input type="radio"/> TLS <input type="radio"/> Auto	
IP Settings	Proxy type	<input type="button" value="-"/> <input type="text" value="Standard"/> <input type="button" value="+"/>	
H323 Settings	Proxy discovery	<input checked="" type="radio"/> Auto <input type="radio"/> Manual	
SIP Settings	Proxy address	10.47.1.58	
Provisioning	Login name	<input type="text"/>	
EMC Resilience Mode	Password	<input type="password"/>	
		<input type="button" value="Save"/>	

Administrator Settings—Provisioning

Provisioning connects you to Callway or VCS. When either of these were ordered and received from Cisco you should also have obtained the necessary information and codes. Just follow the wizard.

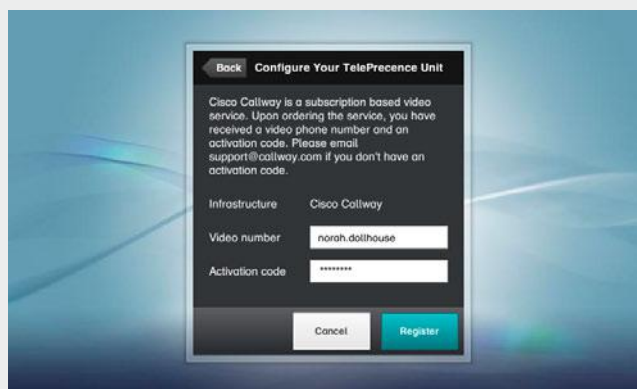
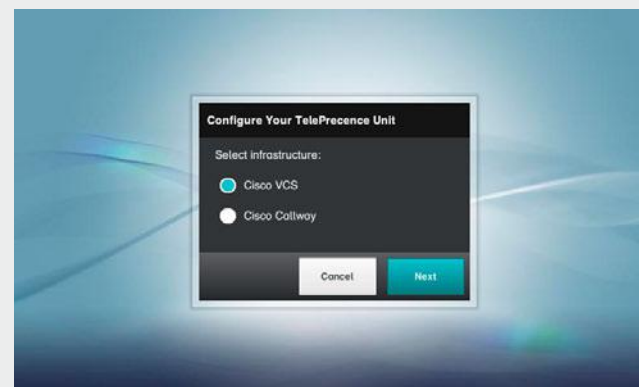
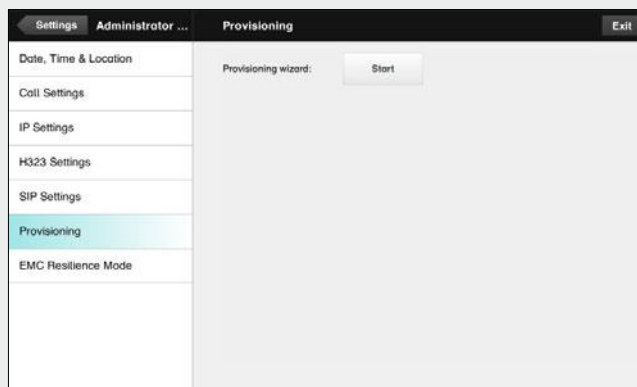

Administrator Settings–EMC Resilience Mode

If the Touch controller is used in environments with considerable amounts of electromagnetic noise present, you may experience an appearance of false signals—as if someone tapped the Touch controller when nobody obviously did so.

To cope with this you may set the **EMC Resilience Mode** to **On**. You must then press and hold for a little while, rather than just tap, in order to make the system aware of your tapping. This will avoid the appearance of false signals.

As long as the system is used in environments without considerable amounts of electromagnetic noise, the setting should be set to Off (as shown).

Settings	Administrator ...	EMC Resilience Mode	Exit
Date, Time & Location		EMC Resilience Mode:	<input type="button" value="OFF"/> <input type="button" value="ON"/>
Call Settings			
IP Settings			
H323 Settings			
SIP Settings			
Provisioning			
EMC Resilience Mode			



Chapter 5

The web interface

Entering the web interface

Key in the IP address of your EX90 in your browser to access its web interface. A detailed description of the options available can be found in the Administrator guide for this product. The Administrator guide is available separately for download.

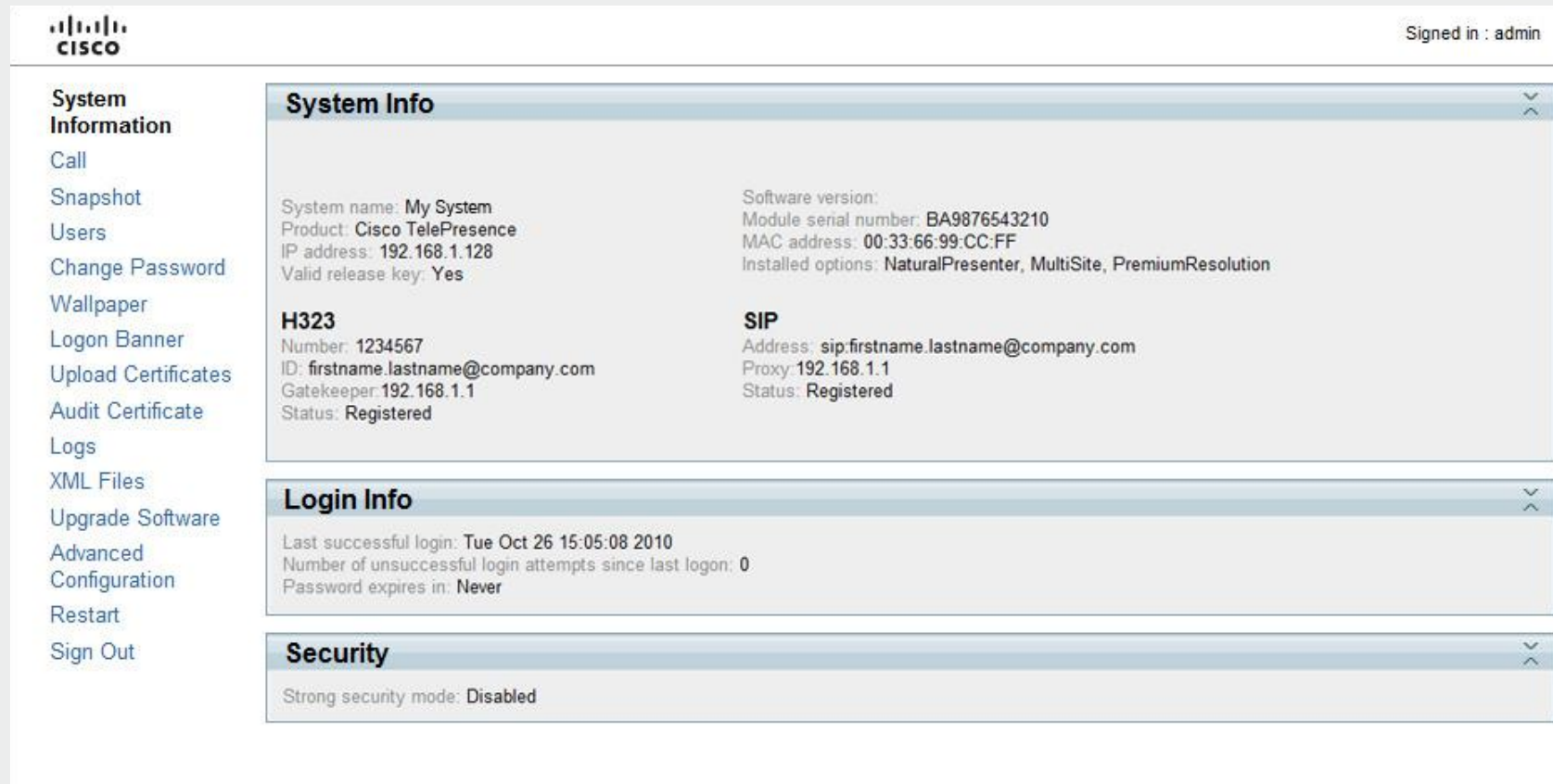

System Information

- Call
- Snapshot
- Users
- Change Password
- Wallpaper
- Logon Banner
- Upload Certificates
- Audit Certificate
- Logs
- XML Files
- Upgrade Software
- Advanced Configuration
- Restart
- Sign Out

System Info

System name: My System
Product: Cisco TelePresence
IP address: 192.168.1.128
Valid release key: Yes

Software version:
Module serial number: BA9876543210
MAC address: 00:33:66:99:CC:FF
Installed options: NaturalPresenter, MultiSite, PremiumResolution

H323

Number: 1234567
ID: firstname.lastname@company.com
Gatekeeper: 192.168.1.1
Status: Registered

SIP

Address: sip.firstname.lastname@company.com
Proxy: 192.168.1.1
Status: Registered

Login Info

Last successful login: Tue Oct 26 15:05:08 2010
Number of unsuccessful login attempts since last logon: 0
Password expires in: Never

Security

Strong security mode: Disabled

Signed in : admin

THE SPECIFICATIONS AND INFORMATION REGARDING THE PRODUCTS IN THIS MANUAL ARE SUBJECT TO CHANGE WITHOUT NOTICE. ALL STATEMENTS, INFORMATION, AND RECOMMENDATIONS IN THIS MANUAL ARE BELIEVED TO BE ACCURATE BUT ARE PRESENTED WITHOUT WARRANTY OF ANY KIND, EXPRESS OR IMPLIED. USERS MUST TAKE FULL RESPONSIBILITY FOR THEIR APPLICATION OF ANY PRODUCTS.

THE SOFTWARE LICENSE AND LIMITED WARRANTY FOR THE ACCOMPANYING PRODUCT ARE SET FORTH IN THE INFORMATION PACKET THAT SHIPPED WITH THE PRODUCT AND ARE INCORPORATED HEREIN BY THIS REFERENCE. IF YOU ARE UNABLE TO LOCATE THE SOFTWARE LICENSE OR LIMITED WARRANTY, CONTACT YOUR CISCO REPRESENTATIVE FOR A COPY.

The Cisco implementation of TCP header compression is an adaptation of a program developed by the University of California, Berkeley (UCB) as part of UCB's public domain version of the UNIX operating system. All rights reserved. Copyright © 1981, Regents of the University of California.

NOTWITHSTANDING ANY OTHER WARRANTY HEREIN, ALL DOCUMENT FILES AND SOFTWARE OF THESE SUPPLIERS ARE PROVIDED "AS IS" WITH ALL FAULTS. CISCO AND THE ABOVE-NAMED SUPPLIERS DISCLAIM ALL WARRANTIES, EXPRESSED OR IMPLIED, INCLUDING, WITHOUT LIMITATION, THOSE OF MERCHANTABILITY, FITNESS FOR A PARTICULAR PURPOSE AND NONINFRINGEMENT OR ARISING FROM A COURSE OF DEALING, USAGE, OR TRADE PRACTICE.

IN NO EVENT SHALL CISCO OR ITS SUPPLIERS BE LIABLE FOR ANY INDIRECT, SPECIAL, CONSEQUENTIAL, OR INCIDENTAL DAMAGES, INCLUDING, WITHOUT LIMITATION, LOST PROFITS OR LOSS OR DAMAGE TO DATA ARISING OUT OF THE USE OR INABILITY TO USE THIS MANUAL, EVEN IF CISCO OR ITS SUPPLIERS HAVE BEEN ADVISED OF THE POSSIBILITY OF SUCH DAMAGES.

Cisco and the Cisco Logo are trademarks of Cisco Systems, Inc. and/or its affiliates in the U.S. and other countries. A listing of Cisco's trademarks can be found at www.cisco.com/go/trademarks. Third party trademarks mentioned are the property of their respective owners. The use of the word partner does not imply a partnership relationship between Cisco and any other company. (1005R)

Any Internet Protocol (IP) addresses and phone numbers used in this document are not intended to be actual addresses and phone numbers. Any examples, command display output, network topology diagrams, and other figures included in the document are shown for illustrative purposes only. Any use of actual IP addresses or phone numbers in illustrative content is unintentional and coincidental.



On our web site you will find an overview of the worldwide Cisco contacts.

Go to: <http://www.cisco.com/web/siteassets/contacts/index.html>

Corporate Headquarters
Ciso Systems, Inc.
170 West Tasman Dr.
San Jose, CA 95134 USA