

JBL ON TOUR™ iBT

Bluetooth® Portable Loudspeaker



Made for
iPod iPhone iPad

OWNER'S MANUAL





IMPORTANT SAFETY INSTRUCTIONS

1. Read these instructions.
2. Keep these instructions.
3. Heed all warnings.
4. Follow all instructions.
5. Do not use this apparatus near water.
6. Clean only with a dry cloth.
7. Do not block any ventilation openings. Install in accordance with the manufacturer's instructions.
8. Do not install near any heat sources such as radiators, heat registers, stoves or other apparatus (including amplifiers) that produce heat.
9. Do not defeat the safety purpose of the polarized or grounding-type plug. A polarized plug has two blades with one wider than the other. A grounding-type plug has two blades and a third grounding prong. The wide blade or the third prong is provided for your safety. If the provided plug does not fit into your outlet, consult an electrician for replacement of the obsolete outlet.
10. Protect the power cord from being walked on or pinched, particularly at plugs, convenience receptacles and the point where they exit from the apparatus.

11. Only use attachments/accessories specified by the manufacturer.
12. Use only with the cart, stand, tripod, bracket or table specified by the manufacturer or sold with the apparatus. When a cart is used, use caution when moving the cart/apparatus combination to avoid injury from tip-over.
13. Unplug this apparatus during lightning storms or when unused for long periods of time.
14. Refer all servicing to qualified service personnel. Servicing is required when the apparatus has been damaged in any way, such as power supply cord or plug is damaged, liquid has been spilled or objects have fallen into the apparatus, the apparatus has been exposed to rain or moisture, does not operate normally, or has been dropped.
15. Do not expose this apparatus to dripping or splashing and ensure that no objects filled with liquids, such as vases, are placed on the apparatus.
16. To completely disconnect this apparatus from the AC Mains, disconnect the power supply cord plug from the AC receptacle.
17. The mains plug of the power supply cord shall remain readily operable.
18. Do not expose batteries to excessive heat such as sunshine, fire or the like.



| | | |
|---|---|---|
|  <p>THE LIGHTNING FLASH WITH AN ARROWHEAD SYMBOL, WITHIN AN EQUILATERAL TRIANGLE, IS INTENDED TO ALERT THE USER TO THE PRESENCE OF UNSULATED "DANGEROUS VOLTAGE" WITHIN THE PRODUCT'S ENCLOSURE THAT MAY BE OF SUFFICIENT MAGNITUDE TO CONSTITUTE A RISK OF ELECTRIC SHOCK TO PERSONS.</p> | <p>CAUTION</p> <p>RISK OF ELECTRIC SHOCK DO NOT OPEN</p> <p>WARNING: TO REDUCE THE RISK OF FIRE OR ELECTRIC SHOCK, DO NOT EXPOSE THIS APPARATUS TO RAIN OR MOISTURE.</p> |  <p>THE EXCLAMATION POINT WITHIN AN EQUILATERAL TRIANGLE IS INTENDED TO ALERT THE USER TO THE PRESENCE OF IMPORTANT OPERATING AND MAINTENANCE (SERVICING) INSTRUCTIONS IN THE LITERATURE ACCOMPANYING THE PRODUCT.</p> |
| <p>SEE MARKING ON BACK OF PRODUCT.</p> | | |

WARNING: THE APPARATUS MAY BE STATIC-SENSITIVE IN SOME CIRCUMSTANCES AND MAY HAVE TO BE RESET AFTER SUFFERING AN ELECTROSTATIC DISCHARGE.

IMPORTANT NOTE FOR ALL ELECTRONIC PRODUCTS: BEFORE INSERTING OR UNPLUGGING AUDIO CABLES FROM THE SOURCE DEVICE'S HEADPHONES OR LINE-LEVEL OUTPUT JACKS, IT IS GOOD PRACTICE TO TURN OFF THE DEVICE. THIS WILL PROLONG THE LIFE OF YOUR UNIT, HELP PROTECT YOUR DEVICE FROM STATIC ELECTRICITY AND AVOID POTENTIAL DAMAGE.

FCC STATEMENT AND WARNING

FCC INFORMATION FOR USERS

This device complies with Part 15 of the FCC Rules. Operation is subject to the following two conditions: (1) This device may not cause harmful interference; and (2) this device must accept any interference received, including interference that may cause undesired operation.

This equipment has been tested and found to comply with the limits for a Class B digital device, pursuant to Part 15 of the FCC Rules. These limits are designed to provide reasonable protection against harmful interference in a residential installation. This equipment generates, uses and can radiate radio frequency energy and, if not installed and used in accordance with the instructions, may cause harmful interference to radio communications. However, there is no guarantee that interference will not occur in a particular installation. If this equipment does cause interference to radio or television reception, which can be determined by turning the equipment off and then on, the user is encouraged to try to correct the interference by one or more of the following measures:

- Reorient the receiving antenna.
- Increase the separation between the equipment and receiver.
- Connect the equipment into an outlet on a circuit different from that to which the receiver is connected.
- Consult the dealer or an experienced radio/TV technician for help.

Any changes or modifications not expressly approved by the party responsible for compliance could void the user's authority to operate the equipment. Industry Canada Statement: This Class B digital apparatus complies with Canadian ICES-003. Cet appareil numérique de la classe B est conforme à la norme NMB-003 du Canada.

JBL ON TOUR™ iBT

INTRODUCTION

With no wires to tangle or restrict your movement, and controls conveniently located on the unit, the JBL On Tour™ iBT loudspeaker is both the ultimate in portable audio convenience and a paragon of superior audio quality.

A compact, high-performance *Bluetooth*® sound center, when paired with your iPad or other *Bluetooth* A2DP-enabled audio device, *Bluetooth* music phone, iPhone, iPod, MP3 player or any other music source with an audio jack, the JBL On Tour iBT loudspeaker will provide clean, powerful sound in a compact, portable design. Accept a phone call with the included *Bluetooth* speakerphone feature. Take complete control of your traveling experience with the JBL On Tour iBT portable loudspeaker.

COMPATIBILITY

The JBL On Tour iBT system is compatible with most *Bluetooth*-enabled devices, music players, cell phones and laptops. Enabled with *Bluetooth* A2DP (Advanced Audio Distribution Profile), AVRCP (Audio/Video Remote Control Profile) and HFP (Hands-Free Profile), the system can stream high-quality sound and serve as a speakerphone. With the included Apple cable and additional stereo mini jack connection, you can enjoy high-quality audio via direct connection with a variety of devices such as iPad, iPhone, iPod, MP3 and CD players, desktop computers (all platforms), laptops and satellite radio tuners.

TABLETOP STAND

Use the included tabletop stand to support your iPad or other *Bluetooth*-enabled tablet while you're streaming to the JBL On Tour iBT. When you're ready to go, snap the stand right to the JBL On Tour iBT unit for easy and convenient transport.

COMPACT DESIGN

The JBL On Tour iBT portable loudspeaker is a complete two-channel audio system in one easy-to-place footprint. The JBL On Tour iBT loudspeaker delivers sound with a powerfully tuned digital audio path. Its clean and compact digital amplification, coupled with DSP (digital signal processing) equalization, efficiently provides the four JBL Odyssey® transducers with cool-running power.

ADVANCED TECHNOLOGY

The JBL On Tour iBT system combines many proprietary technologies to provide the highest-quality sound. It provides astonishing bass and clear, accurate sound from any direction. The four JBL Odyssey full-range transducers are driven by powerful neodymium magnets, and provide accurate sound at all frequencies.

COMPUTER-OPTIMIZED EQUALIZATION AND COMPRESSION

The JBL On Tour iBT system equalization is computer-optimized to provide a rich, complete soundstage. Proprietary compression topology ensures clean, accurate sound at high output levels.

UNPACKING

Carefully unpack your speaker system and identify all its components:

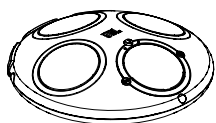

JBL On Tour iBT unit

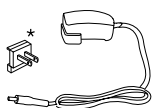

Power supply and outlet adapter*

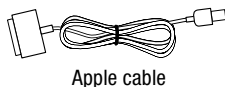

Apple cable

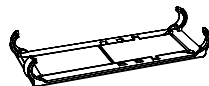

Tabletop stand for tablet media players

*Outlet adapter varies by region.

GENERAL SETUP

Unpack the JBL On Tour iBT system and its power supply.

1. Snap the outlet adapter onto the power supply, plug the power supply into the “12V DC In” port on the back of the unit and then into a wall outlet.
2. Turn on the power switch. The Power LED will glow green.
3. To set up the tabletop stand, pull up the center panels as shown in the illustration and place the tablet player on it. (You can set the stand in one of three positions.)

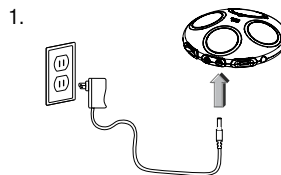

1.

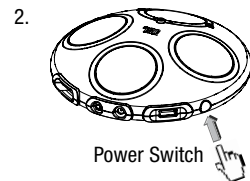

2.

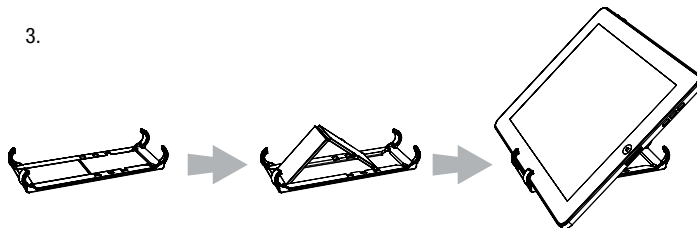

3.

VOLUME CONTROLS

Volume increase “+”

Volume decrease “-”

Phone button “📞”

Microphone “🎤”

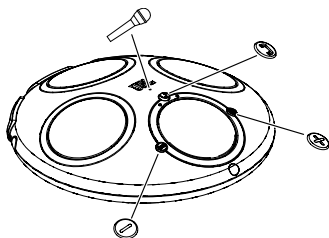

BATTERY INSTALLATION

1. Rotate the battery compartment cover on the bottom of the JBL On Tour iBT speaker to the unlocked position; remove the battery compartment cover.
2. Place (4) fresh AA batteries as shown.
3. Replace the battery compartment cover.

NOTE: The JBL On Tour iBT will not use battery power when using AC power.

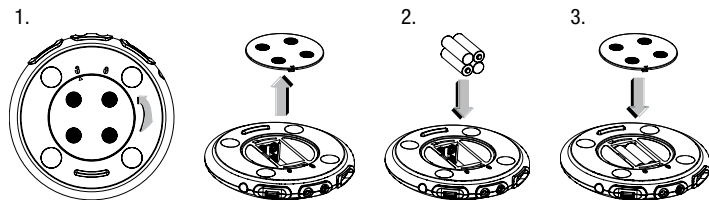

DO NOT MIX BATTERY TYPES.

DO NOT MIX CHARGED AND PARTIALLY CHARGED BATTERIES.

BATTERIES WILL NOT RECHARGE WHILE IN THE UNIT.

CAUTION: Risk of explosion if battery is incorrectly replaced. Replace only with the same or equivalent type.

BATTERY DISPOSAL

Alkaline batteries are considered nonhazardous. Rechargeable batteries (i.e., nickel cadmium, nickel metal-hydride, lithium and lithiumion) are considered hazardous household materials and may pose an unnecessary health and safety risk.

In the European Union and other locations, it is illegal to dispose of any battery with household trash. All batteries must be disposed of in an environmentally sound manner. Contact your local waste management officials for information regarding the environmentally sound collection, recycling and disposal of used batteries.

BLUETOOTH PAIRING

Before you can use your JBL On Tour iBT system with a *Bluetooth*-enabled device, you must pair it with that device.

To pair the JBL On Tour iBT with your device:

1. Make sure your JBL On Tour iBT system is turned on. The JBL On Tour iBT unit automatically goes into Pairing/Discoverable mode, represented by the Source LED flashing blue.
2. Put your *Bluetooth*-enabled device in Pairing mode so both devices can “see” each other. (Refer to the *Bluetooth*-enabled device’s user’s guide for directions and details about putting it into Pairing mode.) The JBL On Tour iBT unit will be represented as “JBL On Tour iBT” on your *Bluetooth*-enabled device. The JBL On Tour iBT password is 0000.
3. The JBL On Tour iBT system is successfully paired and ready to use when the Source LED glows a constant blue.

NOTE: *Bluetooth* pairing between two devices does not have to be repeated after a successful initial pairing, unless the JBL On Tour iBT system has been removed from the *Bluetooth*-enabled device’s *Bluetooth* device list.

LISTENING TO A PHONE CALL FROM A BLUETOOTH-ENABLED DEVICE

1. Make sure the JBL On Tour iBT speaker is paired (see Bluetooth *Pairing* section, on page 5).
2. When you hear your *Bluetooth*-enabled device's ringtone from the JBL On Tour iBT system, press the Phone “📞” button to answer the phone call.

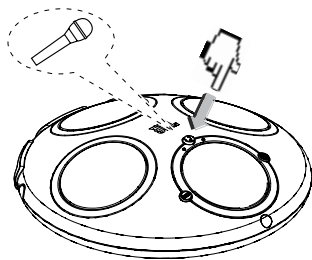

- To reject an incoming phone call: Press and hold the Phone “📞” button on the JBL On Tour iBT unit for two seconds.
- To answer a second incoming phone call while putting the first call on hold: Press the Phone “📞” button.
- To reject a second incoming phone call while staying on the first call: Press and hold the Phone “📞” button for two seconds.

- To mute a phone call: Press both Volume buttons on the JBL On Tour iBT system. To unmute the phone call: Press either Volume button on the JBL On Tour iBT unit.

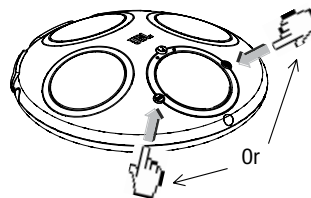

3. When the phone call is finished, press the Phone “📞” button to end the phone call.

MAKING A PHONE CALL FROM A BLUETOOTH-ENABLED DEVICE

To make a phone call via voice recognition mode, press and hold the Phone “📞” button for two seconds.

NOTE: If the phone does not support voice recognition this action will redial the last number that was called on the phone.

LISTENING TO MUSIC

There are three ways to listen to music on your JBL On Tour iBT:

- Via *Bluetooth* technology from a *Bluetooth*-enabled device.
- Using the supplied Apple cable to connect an iPad, iPhone or iPod device to the JBL On Tour iBT's USB port.
- Using a stereo 3.5mm audio cable (not supplied) to connect an audio device's audio or headphone output to the JBL On Tour iBT's auxiliary 3.5mm mini jack.

To cycle through the sources, make sure the JBL On Tour iBT is not in the *Bluetooth* call mode and momentarily press the Phone “

White = Apple cable (USB port)

Blue = *Bluetooth* (wireless)

Green = Auxiliary 3.5mm mini jack

LISTENING TO MUSIC FROM A *BLUETOOTH*-ENABLED DEVICE

1. Make sure the JBL On Tour iBT system is paired with your *Bluetooth*-enabled device (see *Bluetooth Pairing* section, on page 5).
2. Press the JBL On Tour iBT's Phone “
 4. Use the *Bluetooth*-enabled device to control playback. Adjust the volume using the “+” and “-” buttons located on the front of the JBL On Tour iBT unit.

LISTENING TO MUSIC FROM A CONNECTED iPad, iPhone or iPod DEVICE

1. Plug the supplied Apple cable into the JBL On Tour iBT's USB port, and plug your iPad, iPhone or iPod device to the cable's 30-pin connector.

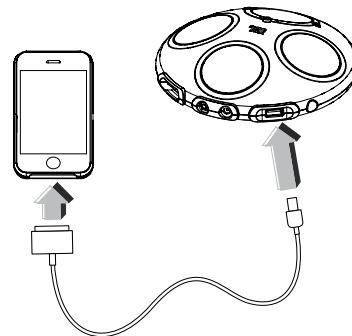

2. Press the JBL On Tour iBT's Phone “

NOTE: When the JBL On Tour iBT is running on AC power, it will recharge the iPad, iPhone or iPod device while it is connected.

LISTENING TO MUSIC FROM A CONNECTED AUXILIARY DEVICE

1. Connect the auxiliary device to the JBL On Tour iBT system using a 3.5mm stereo audio cable (not supplied).

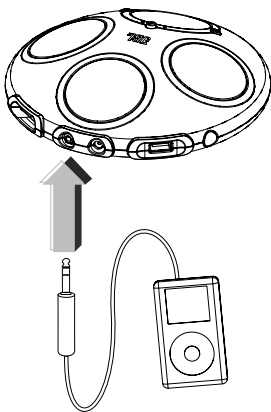

2. Press the JBL On Tour iBT's Phone "📞" button repeatedly until the Source LED lights Amber. This indicates that the Aux input source is selected.
3. Control music playback through the auxiliary device. Adjust the volume using the "+" and "-" buttons located on the front of the JBL On Tour iBT unit.

CHARGING

When the JBL On Tour iBT is running on AC power, the unit's USB port will charge most mobile phones and portable music players. An Apple cable is supplied for charging Apple iPhone, iPod and iPad devices. For other types of devices, use the charging cable that was supplied with your device. If one was not provided, contact the device's manufacturer or an authorized dealer to obtain one. **NOTE:** Mobile phones and portable music players that require data communication in order to charge will not charge from the JBL On Tour iBT unit.

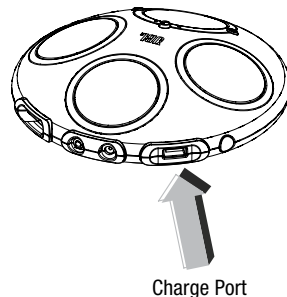

CARRYING/STORING THE TABLETOP STAND

You can easily snap the tabletop stand on and off the JBL On Tour iBT for convenient storage or transport.

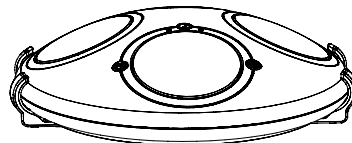

POWER AND SOURCE LEDS

The Power and Source LED colors change to indicate the state of JBL On Tour iBT unit.

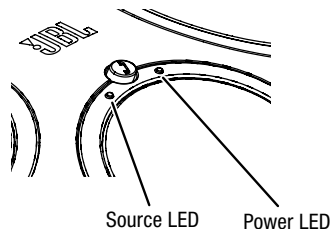

| LED | STATE | INDICATION |
|-------------------|-----------------|--|
| Power LED | Green, constant | JBL On Tour iBT is on, powered by good batteries or its AC power supply. |
| | Amber, constant | Batteries are low. |
| Source LED | White, constant | Apple cable (USB) is the active source. |
| | Blue, constant | <i>Bluetooth</i> source is paired and is the active source. |
| | Blue, flashing | JBL On Tour iBT is in <i>Bluetooth</i> pairing mode. |
| | Green, constant | Aux input connector is the active source. |

SPECIFICATIONS

| | |
|--------------------------------|-------------------------------------|
| Transducers | 4 x JBL Odyssey |
| Amplifier | 2 x 8 watts at 1% THD |
| Frequency response | 100Hz – 20kHz |
| Signal-to-noise ratio | >85dB |
| Input impedance | >10k ohms |
| Battery size/type | AA /alkaline, NiMH |
| Maximum power consumption | 30 watts |
| Power requirement (USA/Canada) | 120 volts, 60Hz AC |
| Power requirement (Europe/UK) | 220 – 230 volts, 50Hz or 60Hz AC |
| Power requirement (Japan) | 100 volts, 50Hz or 60Hz AC |
| Power requirement (Australia) | 240 volts, 50Hz or 60Hz AC |
| Dimensions (Diameter x H) | 6-1/2" x 1-5/8" (165mm x 41mm) |
| Weight | 0.6kg (1.3 lb) |

Features, specifications and appearance are subject to change without notice.

TROUBLESHOOTING SOUND QUALITY

| SYMPTOM | POSSIBLE PROBLEM | SOLUTION | NOTE |
|--|--|---|---|
| There is no sound from your JBL On Tour iBT speaker. | There is no power to the unit. | <p>Make sure the wall power outlet or power strip has power; make sure all switches for the outlet/power strip are on and that all switches for the speaker system are on.</p> <p>Make sure that the batteries are properly installed, and that they are fresh.</p> <p>Ensure that the auxiliary cable is properly connected to an external audio device.</p> | <p>Is the Power LED glowing green? If the Power LED is not on, power is not getting to your JBL On Tour iBT system.</p> <p>Try the solutions shown.</p> |
| | The source selection is incorrect. | <p>Check that the Source LED is lighted the proper color. See <i>Power and Source LEDs</i>, on page 9.</p> <p>Turn up the volume.</p> <p>Check the system with a known good source.</p> <p>Connect the Aux In cable to the headphone jack on your audio device.</p> | |
| Sound comes from only one side/channel. | The source device is not capable of sending music via <i>Bluetooth</i> technology. | Replace the source device with a <i>Bluetooth</i> wireless technology-enabled source device. | |
| | The audio cable is not seated properly. | <p>Make sure the Aux In cable is seated all the way into the JBL On Tour iBT system.</p> <p>Make sure the audio cable is a stereo cable. (A mono cable will only output sound through one channel.)</p> | |

TROUBLESHOOTING SOUND QUALITY (CONTINUED)

| SYMPTOM | POSSIBLE PROBLEM | SOLUTION | NOTE |
|--|---|---|---|
| There is distortion (static, crackling or hissing sounds). | The noise may be caused by interference from a monitor, cell phone or other transmitting device. | Turn the monitor or other device off to see if the noise is eliminated. Move the JBL On Tour iBT cables farther away from the monitor or other device. | |
| There is too much bass or treble. | The JBL On Tour iBT system is being overdriven by an amplified audio source. | Ensure that the JBL On Tour iBT system is connected to an appropriate source device. Make sure that all signal cables are inserted snugly into their connectors. | |
| | The volume level may be too high. | Check the volume of the source device. Some devices will distort the output signal if the volume is set to maximum. | |
| | Check the EQ setting on your source device. | We recommend that the source device EQ be set to Flat or Off. | |
| Your JBL On Tour iBT speaker emits a loud hum or buzzing noise. | The Aux In cable is not plugged in properly. | Check the Aux In cable connection | |
| The speaker experiences radio frequency interference or picks up a radio station. | The input cable may be picking up interference. | Wrap up excess input cable in order to make it as short as possible. | |
| When streaming music using <i>Bluetooth</i> technology, the sound from the JBL On Tour iBT speaker lacks stereo quality. | There is a <i>Bluetooth</i> compatibility issue between the JBL On Tour iBT unit and the source device. | Ensure that the source device has the latest software. Turn both the JBL On Tour iBT unit and the source device both off and on to reset them. | Some source devices have known functional issues with the JBL On Tour iBT system. |

TROUBLESHOOTING CHARGING

| SYMPTOM | POSSIBLE PROBLEM | SOLUTION | NOTE |
|---|----------------------------------|---|---|
| Your iPod device or cell phone will not charge. | The wrong adapter is being used. | Make sure the correct adapter is being used for your specific iPod or cell phone model. | Some cell phones cannot charge via USB without software from the charging system. |

TROUBLESHOOTING PAIRING

| SYMPTOM | POSSIBLE PROBLEM | SOLUTION | NOTE |
|---|---|--|--|
| The audio device does not pair with the JBL On Tour iBT system. | The audio device is not compatible with the JBL On Tour iBT system. | Verify compatibility with the manufacturer. | |
| | The JBL On Tour iBT system is not powered on. | Press the Power button on the JBL On Tour iBT unit. | The blue LED should be flashing, indicating that the system is in the Discoverable mode. |
| | The JBL On Tour iBT system is still paired to the <i>Bluetooth</i> transceiver. | Disconnect the transceiver from the iPod and turn the JBL On Tour iBT system power off, then back on. | |
| | The iPod battery is low. | Charge the JBL On Tour iBT system by following the battery charging directions in this Owner's Manual. | If the amber LED on the JBL On Tour iBT unit is on, it is indicating a low battery. |



HARMAN HARMAN Consumer, Inc.
8500 Balboa Boulevard, Northridge, CA 91329 USA

© 2011 HARMAN International Industries, Incorporated. All rights reserved.

JBL and Odyssey are trademarks of HARMAN International Industries, Incorporated, registered in the United States and/or other countries. JBL On Tour is a trademark of HARMAN International Industries, Incorporated.

The *Bluetooth* word mark and logos are registered trademarks owned by the Bluetooth SIG, Inc., and any use of such marks by HARMAN International Industries, Incorporated, is under license.

iPhone, iPod and iPad are trademarks of Apple, Inc., registered in the U.S. and other countries. "Made for iPod," "Made for iPhone" and "Made for iPad" mean that an electronic accessory has been designed to connect specifically to iPod, iPhone and iPad, respectively, and has been certified by the developer to meet Apple performance standards. Apple is not responsible for the operation of this device or its compliance with safety and regulatory standards. iPod/iPhone/iPad not included.

Features, specifications and appearance are subject to change without notice.

Part No. 950-0351-001