

KEURIG[®] HOT

USE & CARE GUIDE

Classic Series

SINGLE SERVE COFFEE MAKER



IMPORTANT SAFEGUARDS



When using electrical appliances, basic safety precautions should be followed, including the following:

1. Read all instructions before using.
2. Do not touch hot surfaces. Use handles and knobs when available.
3. This appliance must be properly installed and located in accordance with these instructions before it is used.
4. The use of accessory attachments not recommended by the appliance manufacturer may result in fire, electrical shock, or injury to persons.
5. Do not place on or near a hot gas or electric burner, or in a heated oven.
6. Do not use outdoors.
7. To protect against fire, electric shock, and injury do not immerse cords, plugs, or the appliance in water or any other liquid.
8. Do not fill the Water Reservoir above the MAX FILL line.
9. **Use only water in this appliance!** Do not put any other liquids or foods in the Water Reservoir except as instructed in the cleaning instructions in this guide.
10. Turn off and unplug the brewer before cleaning or maintenance. Allow to cool before putting on or taking off parts and before cleaning the appliance.
11. For best operation, plug the appliance into its own electrical outlet on a dedicated circuit to prevent flickering of lights, blowing of fuses, or tripping a circuit breaker.
12. Do not operate any appliance with a damaged Power Cord or plug or after the appliance malfunctions or is damaged in any manner. Contact Keurig Customer Service to report any malfunction of or damage to the brewer.
13. Do not let the Power Cord hang over the edge of the table or counter, or touch hot surfaces.
14. To disconnect, press the Power Button on the brewer to "OFF" status and then remove the plug from the wall outlet.
15. Close supervision is necessary when any appliance is used by or near children.
16. **Do not lift the brewer handle while brewing is in progress.**
17. Always keep the Water Reservoir Lid on the Water Reservoir unless you are refilling it.
18. This appliance is equipped with a Power Cord having a grounding wire with a grounding plug. The appliance must be grounded using a 3-hole properly grounded outlet. In the event of an electrical short circuit, grounding reduces the risk of electrical shock.
19. If the outlet is a standard 2-prong wall outlet, it is your personal responsibility and obligation to have it replaced with a properly grounded 3-prong wall outlet.
20. Do not, under any circumstances, cut or remove the third (ground) prong from the Power Cord or use an adapter.
21. Consult a qualified electrician if the grounding instructions are not completely understood, or if doubt exists as to whether the appliance is properly grounded.
22. Do not use the appliance for other than its intended use.

SAVE THESE INSTRUCTIONS.

WARNING TO USERS AND PARENTS:

1. **DO NOT** permit children to use the brewer unless there is adult supervision. Brewer dispenses very hot water.
2. **SPECIAL NOTICE FOR HOT COCOA/OTHER USERS: IMMEDIATELY AFTER USING A HOT COCOA/OTHER POD, RUN A HOT WATER BREW CYCLE** without a pod to avoid the possibility of clogging the exit needle. **DO NOT** assume the next user will do this.

WARNING

RISK OF FIRE OR
ELECTRIC SHOCK
DO NOT OPEN



WARNING: TO REDUCE THE RISK OF FIRE OR ELECTRIC SHOCK, DO NOT REMOVE THE BOTTOM COVER. NO USER SERVICEABLE PARTS ARE INSIDE. REPAIR SHOULD BE DONE BY AUTHORIZED SERVICE PERSONNEL ONLY.

CAUTION: There are three sharp needles that puncture pods, two above the Pod Holder and the other in the bottom of the Pod Holder. To avoid risk of injury, do not put your fingers in the Pod Holder Assembly.

CAUTION: There is extremely hot water in the Pod Holder during the brew process. To avoid risk of injury, do not lift the Handle or open the Pod Holder Assembly during the brewing process.

CAUTION: Please always keep the brewer in its upright position to avoid potential injury and/or damage to your brewer.

CAUTION: Very hot liquid. Adult supervision required.

SHORT CORD INSTRUCTIONS:

A short power supply cord is provided to reduce the risk of becoming entangled in or tripping over a longer cord. Longer detachable power-supply cords or extension cords are available and may be used if care is exercised in their use. If an extension cord is used, (1) the marked electrical rating of the cord set or extension cord should be at least as great as the electrical rating of the appliance; (2) the cord should be

arranged so that it will not drape over the countertop or tabletop where it can be pulled on by children or tripped over unintentionally; and (3) the extension cord must include a 3-prong grounding plug.

THIS PRODUCT IS FOR HOUSEHOLD USE ONLY.

WARNING

THIS PRODUCT CONTAINS CHEMICALS, INCLUDING LEAD, WHICH IS KNOWN TO THE STATE OF CALIFORNIA TO CAUSE CANCER, BIRTH DEFECTS, OR OTHER REPRODUCTIVE HARM.

KEEP ALL PLASTIC BAGS AWAY FROM CHILDREN

USER GUIDE TABLE OF CONTENTS

KEURIG® CLASSIC SERIES

Features	6
Controls & Indicators	7
Unpacking Instructions	8

SECTION 1

Setup	10
Brew Your First Cup	12

SECTION 2

Controls & Indicators	14
Caring For Your Brewer	15

SECTION 3

Troubleshooting	22
-----------------	----

SECTION 4

Warranty	24
----------	----

SECTION 5

Helpful Hints	26
---------------	----

FEATURES

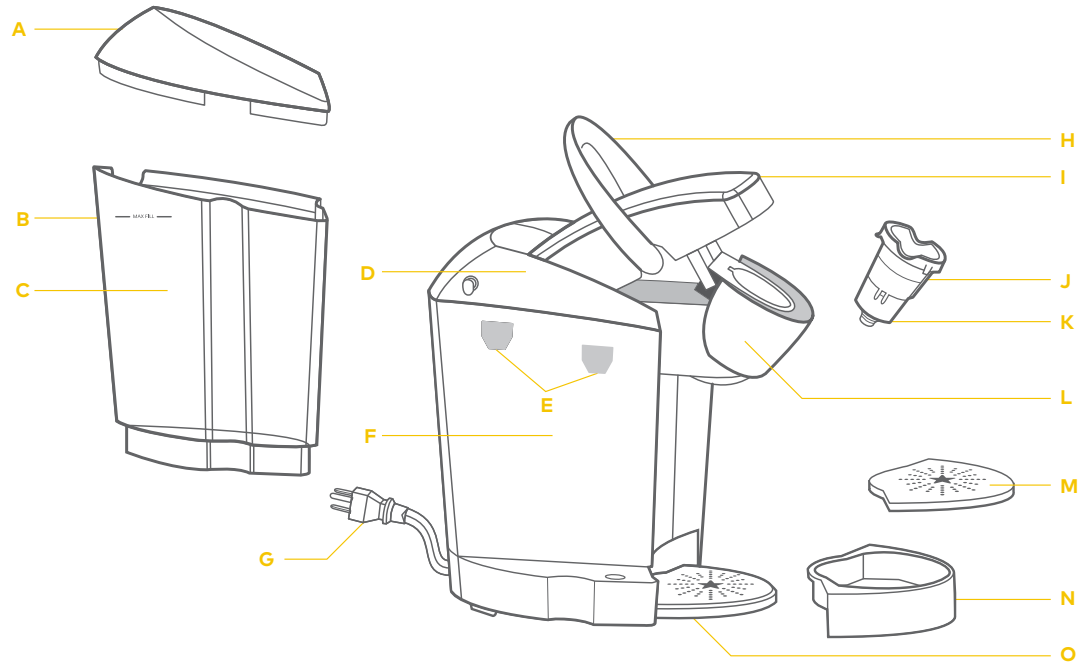

K200 SERIES BREWER

For replacement parts, please visit www.Keurig.com

- | | | |
|-----------------------------------|-------------------------------------------------------------------|--------------------------------|
| A. Water Reservoir Lid | G. Power Cord | K. Funnel |
| B. MAX Fill | H. Handle | L. K-Cup® Pod Assembly Housing |
| C. Water Reservoir | I. Lid | M. Drip Tray Plate |
| D. Vent | J. K-Cup® Pod Holder (J and K are the K-Cup® Pod Holder Assembly) | N. Drip Tray |
| E. Water Reservoir Lock Tab Slots | | O. Drip Tray Base |
| F. Housing | | |

CONTROLS & INDICATORS

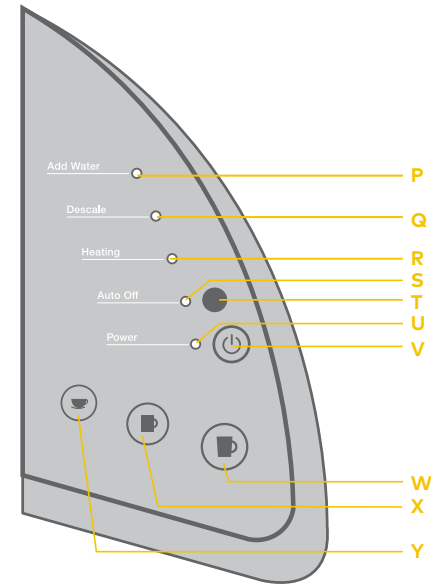

- | | | |
|---------------------------|------------------------|---------------------|
| P. Add Water Light (Blue) | T. Auto Off Button | X. Small Mug Button |
| Q. Descal Light (Red) | U. Power Light (Green) | Y. Small Cup Button |
| R. Heating Light (Red) | V. Power Button | |
| S. Auto Off Light (Green) | W. Large Mug Button | |

UNPACKING INSTRUCTIONS

1. Place brewer box on a large steady surface (such as a table or countertop) or on the floor. Open the box.
2. Remove enclosed literature.
3. Turn the box on its side with front of box face down.
4. Reach into the box and grasp the plastic bag that contains the brewer.
5. Carefully pull the plastic bag (and packaging materials) toward you and out of the box. The brewer will still be encased in the polyfoam and be on its side.
6. Remove the top polyfoam packaging material.
7. Carefully lift brewer off of the bottom polyfoam and place it upright on a flat, steady surface.
8. Lift plastic bag off of brewer.
9. Record the serial number for this brewer on page 5 of this guide. The serial number can be found on the bottom of the brewer box or on the brewer behind the Drip Tray (when removed).
10. Place the brewer upright on a flat, steady surface. Remove tape holding Water Reservoir in place.

We recommend you save all packing materials in case future shipping of the product is necessary.

IMPORTANT: You cannot use your Keurig® brewer until it has been set up for its first use.

NOTE: If brewer has been exposed to temperatures below freezing, allow brewer at least two hours to reach room temperature before brewing. A frozen or extremely cold brewer will not operate.

WARNING:
Keep all plastic bags away
from children.

1 | LET'S GET BREWING!

1. Unwrap cord and plug the brewer into a grounded outlet. Remove all pieces of packing tape.



2. Place a large mug (10 oz. minimum) on the Drip Tray Plate.

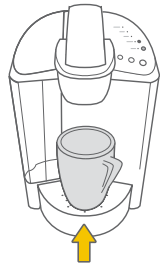

5. Press Power Button found on upper right panel of the brewer. The green Power Light will illuminate.

NOTE: A K-Cup® pod should not be used for this sequence.

NOTE: If the Water Reservoir is empty or not in place on the brewer, the blue Add Water Light will illuminate. The Small Mug Button will not be activated until water is added to the Water Reservoir.



6. The brewer will automatically fill with water and then the water will be heated. This will take about 4 minutes. During the heating period, the red Heating Light will illuminate. Once the water is heated, the red Heating Light will turn off and the Small Cup, Small Mug, and Large Mug Buttons will illuminate.

NOTE: Do not lift Handle during this heating period.

NOTE: You may see small amounts of water coming from the Vent and dripping into the Water Reservoir during this and subsequent heating – this is normal.

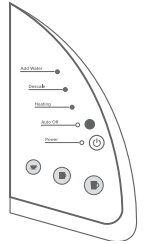

3. Remove the Water Reservoir from brewer by first removing Lid from Reservoir, then lifting Reservoir straight up and away from brewer (may be tight). Rinse with fresh water. Fill Water Reservoir with bottled or filtered water so that the water is to and not beyond the MAX FILL line.



4. Place Water Reservoir base into the left side of the brewer and be sure the Water Reservoir Lock Tabs engage with the brewer. Replace Lid on Water Reservoir.



7. Lift and lower the Handle. Press the Small Mug Button to start a cleansing brew. Pour the hot water into the sink.

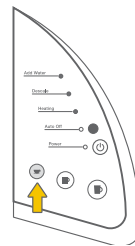

8. The brewer may take 15 seconds to reheat water between brews during which time the red Heating Light may be illuminated. When the water has heated, the red Heating Light will turn off. The one-time setup process is now complete and you are ready to brew!

1. The green Power Light will illuminate to indicate the brewer is powered on. Place a cup or mug on the Drip Tray Plate.

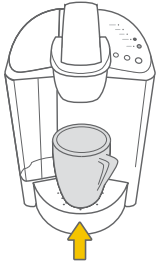

2. Lift the Handle and the K-Cup® pod Holder will open toward you. Select a K-Cup® pod.
NOTE: Do not remove the foil lid or puncture the K-Cup® pod.

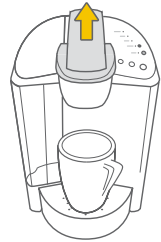

5. There may be a short pause before the brewing process begins. The entire brew process lasts for approximately 1 minute and ends with a burst of air to remove all liquid from the K-Cup® pod. Lift the Handle and dispose of the used K-Cup® pod.
CAUTION: K-Cup® pod will be hot.



6. Enjoy your first cup of gourmet coffee, tea, or hot cocoa from your Keurig® brewer!

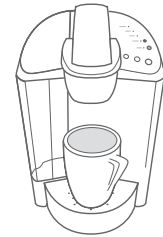

3. Place a K-Cup® pod in the K-Cup® Pod Holder. Lower the Handle completely to close the Lid.

CAUTION: There are two sharp needles that puncture the K-Cup® pod, one above the K-Cup® Pod Holder and the other in the bottom of the K-Cup® Pod Holder. To avoid risk of injury, do not put your fingers in the K-Cup® Pod Holder.

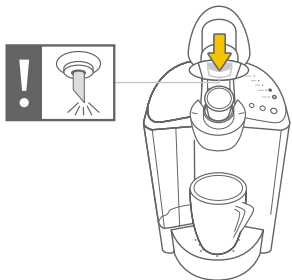

4. Select your brew size: The Small Cup choice will yield a 5.25 oz. serving, the Small Mug will yield a 7.25 oz. serving and the Large Mug will yield a 9.25 oz. serving. The blue Brew Button you choose will remain illuminated while brewing.

NOTE: If you do not push a Brew Button in 60 seconds, the Brew Buttons will be disabled to prevent accidental activation. Re-activate the Brew Buttons by lifting and lowering the Handle completely.

CAUTION: There is extremely hot water in the K-Cup® Pod Holder during the brew process. To avoid risk of injury, do not lift the Handle or open the K-Cup® Pod Assembly Housing during the brew process.



7. The red Heating Light may be illuminated as the water is heated for the next brew cycle. The brewer will be ready for use in approximately 15 seconds.

NOTE: During this period, your brewer will prepare for the next brew. The pump may make a vibrating sound. This is normal.

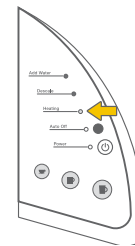

**PROGRAMMING AUTO OFF
TIMER FEATURE**

To set the brewer to turn off two hours after the last brew follow the steps below.

1. Press the Power Button to turn on the brewer.

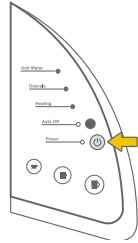

2. Press the black Auto Off Button to turn on the Auto Off Timer feature. The green Auto Off Light will illuminate. When the Auto Off Timer is enabled, your brewer will automatically turn off two hours after your last brew.

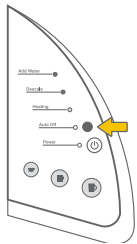

3. To disable the Auto Off Timer, simply press the black Auto Off Button again and the green Auto Off Light will turn off.

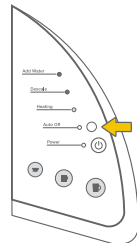

CLEANING EXTERNAL PARTS

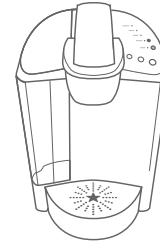

CLEANING THE BREWER EXTERIOR

Keep your Keurig® Classic Series brewer looking its best by cleaning the exterior from time to time. Just clean with a damp, soapy, lint-free, non-abrasive cloth. Never immerse the brewer in water or other liquids.



CLEANING THE DRIP TRAY

The Drip Tray can accumulate up to 8 ounces of overflow. The Drip Tray and the Drip Tray Plate should occasionally be rinsed clean. To remove the Drip Tray, simply slide it toward you, keeping it level at all times to avoid spilling. Clean with a damp, soapy, lint-free, non-abrasive cloth.

CLEANING THE K-CUP® POD HOLDER ASSEMBLY

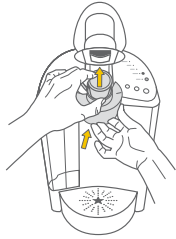

Cleaning the Parts The K-Cup® Pod Holder Assembly can be placed onto the top shelf of a dishwasher. NOTE: Use low temperature cycles in the dishwasher. To remove from the brewer, lift the Handle and grasp the top of the K-Cup® Pod Holder with one hand while pushing up on the bottom of the K-Cup® Pod Holder from underneath with the other until it releases. After cleaning, align the K-Cup® Pod Holder with the opening using the two front ribs as a guide and snap into place from the top.



Cleaning the Funnel The Funnel can be removed from the K-Cup® Pod Holder by pulling on it until it pops off. The Funnel is dishwasher safe. To replace it, just snap it back onto the K-Cup® Pod Holder Assembly.

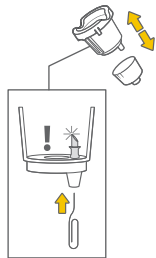

Cleaning the Exit Needle The Exit Needle is located on the inside bottom of the K-Cup® Pod Holder Assembly. Should a clog arise due to coffee grinds, it can be cleaned using a paper clip or similar tool. Remove K-Cup® Pod Holder Assembly and detach Funnel. Insert the paper clip into the Exit Needle to loosen the clog and push it out. The K-Cup® Pod Holder is dishwasher safe.

CAUTION: There are sharp needles that puncture the K-Cup® pod above the K-Cup® Pod Holder and in the bottom of the K-Cup® Pod Holder. To avoid risk of injury, do not put your fingers in the K-Cup® Pod Assembly Housing.

CLEANING THE WATER RESERVOIR & WATER RESERVOIR LID

The Water Reservoir Lid and Water Reservoir should be periodically inspected and cleaned.

The Water Reservoir Lid or Water Reservoir should not be put into the dishwasher. They should be cleaned with a damp, soapy, non-abrasive cloth and rinsed thoroughly. Do not dry the inside of the Water Reservoir with a cloth as lint may remain.

To clean the filter screen at the base of your Water Reservoir, empty the Water Reservoir and follow one or all of the following procedures.

NOTE: If you are using a water filter inside the Water Reservoir, remove it before cleaning.

1. Rinse the filter screen with the strong force of water from your faucet.
2. If you have a sprayer, aim the water spray at the filter screen.
3. Fill the Water Reservoir with approximately two inches of clean water and agitate (shake) the Water Reservoir.

Empty the Water Reservoir then fill it with clean water and return it to the brewer. If needed, repeat above procedures.

CAUTION: Please rinse the Water Reservoir thoroughly after cleaning. This will ensure that no cleaners or cleaning solutions remain in this area as they may contaminate the water supply in the brewer.

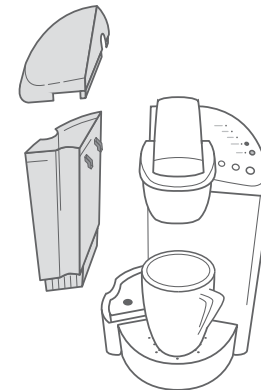

DESCALING YOUR BREWER

Depending on the mineral content of your water, calcium deposits or scale may build up in your brewer. Scale is non-toxic but if left unattended can hinder brewer performance. Regularly descaling your brewer every 3-6 months helps maintain the heating element, and other internal parts that come in contact with water. Calcium deposits may build up faster, making it necessary to descale more often.

You should promptly descale if the red Descale Light is illuminated. However, even if the red Descale Light is not illuminated you should continue to descale your brewer every 3-6 months. Properly follow the descaling procedure.

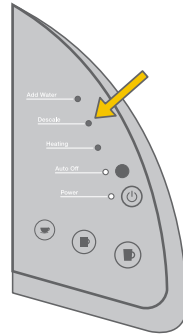
**DESCALING PROCEDURE**

Before you begin, you will need a large ceramic mug, fresh water, descale solution, and access to a sink. Do not use a paper cup.

- Empty the water from the Water Reservoir. If there is a Keurig® Water Filter, remove and set aside. Disable "Auto Off" features, if necessary (refer to page 14).

STEP 1: FIRST DESCALING SOLUTION RINSE

- Press the Power Button to power the brewer off.
- Pour the entire bottle of Keurig® Descaling Solution into the Water Reservoir. Then fill the empty bottle with water and pour into the Water Reservoir. Press the Power Button to turn the brewer back on.
- Place a large mug on the Drip Tray Plate and run a cleansing brew using the largest brew size. Do not use a K-Cup® pod. Pour the contents of the mug into the sink.

STEP 2: SECOND DESCALING SOLUTION RINSE

- Repeat the brew process without a K-Cup® pod, until ADD WATER is indicated. Let brewer stand for at least 30 minutes while still on.
- After 30 minutes, discard any residual solution and rinse the Water Reservoir thoroughly.

STEP 3: FRESH WATER RINSE

- Ensure the Water Reservoir is filled with fresh water to and not beyond the MAX FILL line.
- Place a large mug on the Drip Tray Plate and run a cleansing brew using the largest brew size. Do not use a K-Cup® pod. Pour the contents of the mug into the sink.
- Repeat brew process until you have completed at least 12 brews using the largest brew size. You may need to refill the Water Reservoir at least one time during this process.

NOTE: If the red Descale Light is still illuminated after completing the procedure, repeat the descaling procedure above.

NOTE: The cleaning action of Keurig™ Descaling Solution may result in a foam dispensed from the brewer. This is natural, as the solution is reacting with the scale inside. For a brewer that is heavily scaled, the brewer may not fill properly after the descaler is added. If this occurs, you may see only a small or no output dispensed followed by the sound of air blowing out. If this occurs:

- Turn off and unplug the brewer.
- If there is Keurig® Descaling Solution in the Water Reservoir, discard the contents, rinse the Water Reservoir thoroughly and refill with water.
- Plug the brewer back in, power on, and repeat the Step 3 Fresh Water Rinse cycle. The brewer should begin to function normally as the solution is rinsed out and the scale is removed. If problem persists, allow brewer to sit unplugged for at least 30 minutes before continuing with the rinse.

Visit us online for more information at www.Keurig.com/descaling.

SERVICE

Beyond these recommended cleaning and maintenance procedures, this brewer is not user serviceable. For service, please refer to the Warranty section of this guide.

STORAGE

Empty the Water Reservoir before storing and take care to ensure that you store your brewer in a safe and frost free environment. Please be sure to store your brewer in its upright position to avoid water leakage from the inner tank. If you store the brewer in a cold environment, you run the risk of water freezing inside the brewer and causing damage. When you prepare to use it after storage, we recommend rinsing the Water Reservoir with fresh water and running three cleansing brews without a K-Cup® pod.

If you plan to move your brewer to a different location, turn the brewer off, unplug it and empty the Water Reservoir. If your brewer has been in an environment below freezing, please be sure to let it warm to room temperature for at least 2 hours before using.

INSTRUCTIONAL VIDEOS AVAILABLE ONLINE

You can watch step by step videos on cleaning, descaling, and more. Visit www.Keurig.com/customer-service



HAVE QUESTIONS? WE'RE HERE TO HELP

Keurig is committed to your satisfaction. If you have questions, just give us a call to have them answered quickly without leaving the comfort of your home. **1.866.901.BREW (2739)**

BREWER DOES NOT HAVE POWER

- Plug brewer into an independent outlet.
 - Check to be sure that it is plugged in securely.
 - Plug into a different outlet.
 - Reset your home's circuit breaker, if necessary.
 - Make sure that the Power Button has been turned on and the green Power Light is illuminated.
-

BREWER WILL NOT BREW

- After placing the K-Cup® pod in the K-Cup® Pod Holder, make sure that the Handle is pushed down securely and the blue Brew Buttons are flashing.
 - If the blue Add Water Light is illuminated, add water to Water Reservoir. Fill to and not beyond the MAX FILL line. Make sure the Water Reservoir is seated properly in its base.
 - If the blue Add Water Light continues to be illuminated even after refilling, contact Customer Service at 1.866.901.BREW (2739).
 - If the blue Add Water Light, red Heating Light, and Small Mug Button are all flashing simultaneously, see next situation.
-

BLUE ADD WATER LIGHT, RED HEATING LIGHT, AND SMALL MUG BUTTON ARE ALL FLASHING SIMULTANEOUSLY

- Completely remove the Water Reservoir and thoroughly clean (refer to page 17). Ensure the Water Reservoir is filled to and not beyond the MAX FILL line. Return it to the brewer and ensure it is seated properly, then press the flashing Small Mug Button.
- If you have completed the above procedure two times and the situation persists, contact Customer Service at 1.866.901.BREW (2739).

BREWING A PARTIAL CUP

- The Exit Needle may be clogged (refer to page 16).
 - Clean K-Cup® Pod Holder if necessary and rinse under faucet (refer to page 16).
 - The Water Reservoir may have been removed during brewing. Replace the Water Reservoir and perform a cleansing brew without a K-Cup® pod.
 - If the red Descale Light is illuminated, descale the brewer (refer to page 19).
 - If you have repeated the descale procedure on your brewer two times and it is still only brewing a partial cup, contact Customer Service at 1.866.901.BREW (2739).
-

BREWER SHUTS OFF AUTOMATICALLY

- Check to make sure that the Auto Off Timer feature has not been enabled. If the green Auto Off Light is illuminated, press the black Auto Off Button to disable the Auto Off Timer feature.
-

WATER APPEARS IN THE BREWER BASE WITH THE WATER RESERVOIR REMOVED

- It is normal for a small amount of water (less than 10 ml) to collect if the Water Reservoir is not seated for a period of time. This will not affect the operation of the brewer.
- Use clean cloth or paper towel to absorb the water.
- Return the Water Reservoir back to the brewer base (refer to page 17).

If any problems persist, contact Customer Service at 1.866.901.BREW (2739)

LIMITED ONE YEAR WARRANTY

Keurig Green Mountain, Inc. (Keurig) warrants that your brewer will be free of defects in materials or workmanship **under normal home** use for one year from the date of purchase. It is recommended that you fill out and return the warranty card enclosed with your brewer so that your purchase information will be stored in our system. Keurig will, at its option, repair or replace a defective brewer without charge upon its receipt of proof of the date of purchase. If a replacement brewer is necessary to service this warranty, the replacement brewer may be new or reconditioned. If a replacement brewer is sent, a new limited one year warranty will be applied to the replacement brewer.

This warranty only applies to brewers operated in the United States and Canada. This warranty gives you specific legal rights, and you may also have other rights that vary from state to state and, in the case of Canada, from province to province.

Only the use of Keurig® K-Cup® brand pods and accessories will guarantee the proper functioning and lifetime of your Keurig® brewer. Any damage to or malfunction of your brewer resulting from the use of non-Keurig® pods and accessories may not be covered by this warranty or may result in a service fee if the damage or malfunction is determined to be caused by such use.

WHAT IS NOT COVERED BY THE LIMITED WARRANTY?

THIS WARRANTY DOES NOT COVER CONSEQUENTIAL OR INCIDENTAL DAMAGES SUCH AS PROPERTY DAMAGE AND DOES NOT COVER INCIDENTAL COSTS AND EXPENSES RESULTING FROM ANY BREACH OF THIS WARRANTY, EVEN IF FORESEEABLE. Some states or provinces do not allow the exclusion or limitations of incidental or consequential damages, so the above limitation or exclusion may not apply to you depending on the state or province of purchase.

Nor does this warranty cover damages caused by use of non-Keurig® pods or accessories, services performed by anyone other than Keurig or its authorized service providers, use of parts other than genuine Keurig® parts, or external causes such as abuse, misuse, inappropriate power supply, or acts of God.

OTHER LIMITATIONS

THIS WARRANTY IS EXCLUSIVE AND IS IN LIEU OF ANY OTHER EXPRESS WARRANTY, WHETHER WRITTEN OR ORAL. IN ADDITION, KEURIG HEREBY SPECIFICALLY DISCLAIMS ALL OTHER WARRANTIES WITH RESPECT TO YOUR K10 MINI PLUS BREWER, INCLUDING ANY IMPLIED WARRANTY OF MERCHANTABILITY OR FITNESS FOR ANY PARTICULAR PURPOSE. Some states or provinces do not allow disclaimers of such implied warranties or limitations on how long an implied warranty lasts, so the above limitation may not apply to you depending on the state or the province of purchase.

HOW DO YOU OBTAIN WARRANTY SERVICE?

Keurig® brewers are high-quality appliances and, with proper care, are intended to provide years of satisfying performance. However, should the need arise for warranty servicing, simply call Keurig Customer Service at our toll free phone number 1.866.901.BREW (2739). Please do not return your brewer for servicing without first speaking to Keurig Customer Service to obtain an Authorization to Return number (ATR). Keurig® brewers returned without an ATR number will be returned to the sender without servicing.

Keurig Green Mountain, Inc.
33 Coffee Lane
Waterbury, VT 05676
1.866.901.BREW (2739)

 **PLUG BREWER INTO ITS OWN GROUNDED OUTLET**

If the electric circuit is overloaded with other appliances, your brewer may not function properly. The brewer should be operated on its own circuit, separate from other appliances.

 **KEEP YOUR BREWER TURNED "ON"**

To brew a fresh cup of coffee, tea, or hot cocoa anytime you want, keep your brewer turned "ON" all the time. However, you can set the brewer to automatically turn off two hours after your last brew. Follow the simple instructions on page 14 to make using the brewer convenient for you.

 **FOR THE BEST TASTING GOURMET COFFEE, TEA, OR HOT COCOA, KEURIG RECOMMENDS USING BOTTLED OR FILTERED WATER**

Water quality varies from place to place. If you notice an undesirable taste in your cup of coffee, tea, or hot cocoa (such as chlorine or other mineral tastes) we recommend you consider using bottled water or water from a filtration system. For best results, carefully follow manufacturer's instructions when using any water filtration system.

 **CUSTOMIZE THE SIZE, FLAVOR & BREW THAT'S PERFECT FOR YOU**

With the choice of over 500 varieties of K-Cup® pods and 3 brew sizes (Small Cup-5.25 oz., Small Mug-7.25 oz., and Large Mug-9.25 oz.), your Keurig® brewer gives you endless options to customize the size, flavor and brew that's perfect for you.

 **REMOVE K-CUP® POD AFTER USE**

Please see page 12 for brewing instructions.

 **BREWING INTO A TRAVEL MUG**

To brew into a travel mug, simply remove the Drip Tray Assembly and place the travel mug on the Drip Tray Base.

 **DESCALE BREWER REGULARLY**

Please see pages 19 for instructions.



Keurig Green Mountain, Inc.

33 Coffee Lane

Waterbury, VT 05676

1.866.901.BREW (2739)

P/N | Pièce n° | Pieza n.º DC0000000263 Rev A

11/15

