

Figures and illustrations in this User Manual are provided for reference only and may differ from actual product appearance. Product design and specifications may be changed without notice.

Important Warranty Information Regarding Television Format Viewing

See the warranty card for more information on warranty terms.

Wide screen format LED Displays (16:9, the aspect ratio of the screen width to height) are primarily designed to view wide screen format full-motion video. The images displayed on them should primarily be in the wide screen 16:9 ratio format, or expanded to fill the screen if your model offers this feature and the images are constantly moving. Displaying stationary graphics and images on screen, such as the dark sidebars on non-expanded standard format television video and programming, should be limited to no more than 5% of the total television viewing per week. Additionally, viewing other stationary images and text such as stock market reports, video game displays, station logos, web sites, or computer graphics and patterns, should be limited as described above for all televisions. Displaying stationary images that exceed the above guidelines can cause uneven aging of LED Displays that leave subtle, but permanent burned-in ghost images in the LED picture. To avoid this, vary the programming and images, and primarily display full screen moving images, not stationary patterns or dark bars. On LED models that offer picture sizing features, use these controls to view different formats as a full screen picture. Be careful in the selection and duration of television formats you use for viewing. Uneven LED aging as a result of format selection and use, as well as burned-in images, are not covered by your Samsung limited warranty.

SAMSUNG ELECTRONICS NORTH AMERICAN LIMITED WARRANTY STATEMENT

Subject to the requirements, conditions, exclusions and limitations of the original Limited Warranty supplied with Samsung Electronics (SAMSUNG) products, and the requirements, conditions, exclusions and limitations contained herein, SAMSUNG will additionally provide Warranty Repair Service in the United States on SAMSUNG products purchased in Canada, and in Canada on SAMSUNG products purchased in the United States, for the warranty period originally specified, and to the Original Purchaser only.

The above described warranty repairs must be performed by a SAMSUNG Authorized Service Center. Along with this Statement, the Original Limited Warranty Statement and a dated Bill of Sale as Proof of Purchase must be presented to the Service Center.



BN68-05495A-02

Add to Favorite/Delete from Favorite

Lets you add channels to and delete channels from your Favorites list.

To add channels to the Favorites list, follow these steps:

1. Select one or more channels in the All Channels list using the ▲/▼ buttons and the Yellow Select button on your remote.
2. Press the TOOLS button on your remote. The Tools menu appears.
3. Select Add to Favorite in the Tools menu, and then press the ENTER button.

To delete channels from the Favorites list, follow these steps:

1. Select one or more channels in the Favorite Channels list using the ▲/▼ buttons and the Yellow Select button on your remote.
2. Press the TOOLS button on your remote. The Tools menu appears.
3. Select Delete from Favorite in the Tools menu, and then press the ENTER button.

Timer Viewing

Let you set a channel to be displayed automatically at a set time, even when you are watching another channel. You must set the current time first in the Time > Clock function to use Time Viewing.

To schedule a channel, follow these steps:

1. Select a channel in the Added Channels list using the ▲/▼ buttons and the Yellow Select button on your remote.
2. Press the TOOLS button on your remote. The Tools menu appears.
3. Select Time Viewing in the Tools menu, and then press the ENTER button. The Time Viewing screen appears.

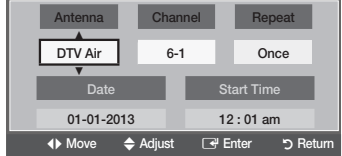

4. Use the ▲/▼ buttons to move from entry field to entry field and the ▲/▼ buttons to change the entries. Where numbers are displayed, you can also enter numbers directly using the number keypad on your remote.

Transportation to and from the Service Center is the responsibility of the purchaser. Conditions covered are limited only to manufacturing defects in material or workmanship, and only those encountered in normal use of the product. Excluded, but not limited to, are any originally specified repairs for, in-home or on-site services, minimum or maximum repair times, exchanges or replacements, accessories, options, upgrades, or consumables.

For the location of a SAMSUNG Authorized Service Center, please call toll-free:

— In the United States : 1-800-SAMSUNG (1-800-726-7864)

— In Canada : 1-800-SAMSUNG

Still image warning

Avoid displaying still images (such as jpeg picture files) or still image elements (such as TV channel logos, TV shows or movies in panorama or 4:3 format, stock or news scroll bars, etc.) on the screen. The constant display of still pictures can cause ghosting or image burn-in (image retention) on the LED screen, which will affect image quality. To reduce the risk of this effect, please follow the recommendations below:

- Avoid displaying the same TV channel for long periods.
- Always try to display any image in full screen mode. Use the TV's Picture Options menu to select the optimal screen size.
- Reduce brightness and contrast values to the minimum required to achieve the desired picture quality. Values that exceed the minimum may speed up the burn-in process.
- Frequently use all TV features designed to reduce image retention and screen burn-in. Refer to proper user manual section for details.

Contact SAMSUNG WORLDWIDE		
If you have any questions or comments relating to Samsung products, please contact the SAMSUNG customer care center.		
Country	CANADA	U.S.A.
Address	Samsung Electronics Canada Inc., Customer Service 55 Sandhill Court, Mississauga, Ontario L5R 4B2 Canada	Samsung Electronics America, Inc. 85 Challenger Road Ridgefield Park, NJ 07090
Customer Care Center	1-800-SAMSUNG(726-7864)	
Web Site	www.samsung.com/ca (English) www.samsung.com/ca_fr (French)	www.samsung.com/us

© 2013 Samsung Electronics Co., Ltd. All rights reserved.

The On Screen Menus

Your TV has two kinds of menus, the Main menu and the various Tools menus. The Main menu gives you access to most or all of the menu options available on your TV. The Tools menus display a selected number of frequently used menu options that change depending on the screen you are viewing. A Tools menu symbol (I) in the lower right side of the screen indicates that a Tools menu is available.

The Main menu has seven primary categories:

- Picture
- Sound
- Channel
- Setup
- Input
- Application
- Support

To view the Main menu, press the MENU button on your remote. To view a Tools menu, press the TOOLS button on your remote.

The menu options that appear in the Main menu depend on the Source you have selected. For example, if you have selected the HDMI source, the Channel category will not appear. To see the Channel category, you must first select TV in the Source List.

The Menu options are presented below, arranged by Main menu categories. A Tools button symbol (TOOLS) next to an option name indicates the option is also available in one of the Tools menus.

Picture Menu

Mode

Select your preferred picture mode.

- When your TV is connected to a PC, you can only select **Entertain and Standard**.
- **Dynamic**: Brightens the screen. Suitable for a bright room.
- **Standard**: Suitable for a normal.
- **Movie**: Darkens the screen, making it less glary. Suitable for watching movies in a darkened room.
- **Entertain**: Sharpens the picture. Suitable for games.
- Only available when the TV is connected to a PC.

Backlight / Contrast / Brightness / Sharpness / Color / Tint (G/R)

- **Backlight**: Adjusts the brightness of the screen by adjusting the brightness of the individual pixels.
- **Contrast**: Increases or decreases the contrast between dark and light areas of the picture.
- **Brightness**: Adjusts the brightness of the screen. Not as effective as Backlight.
- **Sharpness**: Sharpens or dulls the edges of objects.
- **Color**: Adjusts the color saturation. The higher the Color setting, the more intense the color. Low settings remove color and the picture becomes black, white and gray.
- **Tint (G/R)**: Adjusts the amount of green and red in the picture. As you increase the amount of green, the amount of red decreases and vice versa.
- When the TV is connected to a PC, you can only make changes to **Backlight, Contrast, Brightness, and Sharpness**.

Advanced Settings

Available in **Standard** and **Movie** mode only.

Compared to previous models, new Samsung TVs offer a more precise picture with more precise controls.

- When your TV is connected to a PC, you can only make changes to **Gamma and White Balance**.
- **Color Space (Auto / Native)**: Auto automatically matches the range of colors available to create pictures to the color range of the video source. Native provides a color range wider than the color range of the video source.
- **White Balance**: Adjusts the color temperature of the picture so that white objects look white (instead of, for example, slightly pink or slightly yellow) and the overall color of the picture looks natural.
 - **R-Offset / G-Offset / B-Offset**: Adjusts each color's (red, green, blue) darkness.
 - **R-Gain / G-Gain / B-Gain**: Adjusts each color's (red, green, blue) brightness.
- **Reset**: Resets the **White Balance** to it's default settings.
- **Gamma**: Adjusts the primary color intensity.
- **Dynamic Contrast (Off / Low / Medium / High)**: Adjusts the screen contrast.
- **Black Tone (Off / Dark / Darker / Darkest)**: Selects the black level to adjust the screen depth. Darker settings make blacks look darker.
- **Flesh Tone**: Adjusts the amount of red in skin tones.
- **Motion Lighting (Off / On)**: When on, the TV automatically adjusts the brightness of the screen in response to the brightness of the room. In bright light, the screen brightens. In dim light, the screen dims.
- Available in **Standard** mode only.

Picture Options

When the TV is connected to a PC, you can only make changes to the **Color Tone, Size and HDMI Black Level**.

- **Color Tone (Cool / Standard / Warm / Warm2)**: Cool makes the picture blur (cooler). Warm 1 and Warm 2 make the picture redder (warmer).
- **Warm1 and Warm2** are deactivated when the picture mode is set to **Dynamic**.
- **Size**: Set the size and aspect ratio of the picture on the screen. Your cable box or satellite receiver may have its own set of screen sizes as well. However, we highly recommend you use the TV's 16:9 mode most of the time.
- **16:9**: Sets the picture to the 16:9 wide screen format.
- **Zoom1**: Provides moderate magnification of the picture. Sides, top, and bottom are cut off.
- **Zoom2**: Provides large magnification of the picture. Sides, top, and bottom are cut off.
- **Wide Fit**: Enlarges the aspect ratio of the picture so the picture fits the entire screen.
- **4:3**: Sets the picture to the old, 4:3 format and puts black or gray borders on the right and left of the picture.
- Do not watch your TV in the 4:3 format for a long time. Traces of borders displayed on the left, right and center of the screen may cause image retention (screen burn) which is not covered by the warranty.

Screen Fit: Displays the full image without any cut-off when your TV is inputting HDMI (720p / 1080i / 1080p) or Component (1080i / 1080p) HD signals.

HD (High Definition) has a 16:9 aspect ratio and 1080i/1080p (1920x1080) or 720p (1280x720) resolution.

You can adjust and store settings for each external device you have connected to an input on the TV. Picture Sizes available by Input Source are listed below:

—

—

—

—

—

—

—

—

—

—

—

—

—

—

—

—

—

—

—

—

—

—

—

—

—

—

—

—

—

—

—

—

—

—

—

—

Input Source

ATV, AV, Component (480, 480p)

DTV (1080i, 1080p), Component (1080i, 1080p), HDMI (720p, 1080i, 1080p)

DTV (1080i, 1080p), Component (1080i, 1080p), HDMI (720p, 1080i, 1080p)

DTV (1080i, 1080p), Component (1080i, 1080p), HDMI (720p, 1080i, 1080p)

DTV (1080i, 1080p), Component (1080i, 1080p), HDMI (720p, 1080i, 1080p)

DTV (1080i, 1080p), Component (1080i, 1080p), HDMI (720p, 1080i, 1080p)

DTV (1080i, 1080p), Component (1080i, 1080p), HDMI (720p, 1080i, 1080p)

DTV (1080i, 1080p), Component (1080i, 1080p), HDMI (720p, 1080i, 1080p)

DTV (1080i, 1080p), Component (1080i, 1080p), HDMI (720p, 1080i, 1080p)

DTV (1080i, 1080p), Component (1080i, 1080p), HDMI (720p, 1080i, 1080p)

DTV (1080i, 1080p), Component (1080i, 1080p), HDMI (720p, 1080i, 1080p)

DTV (1080i, 1080p), Component (1080i, 1080p), HDMI (720p, 1080i, 1080p)

DTV (1080i, 1080p), Component (1080i, 1080p), HDMI (720p, 1080i, 1080p)

DTV (1080i, 1080p), Component (1080i, 1080p), HDMI (720p, 1080i, 1080p)

DTV (1080i, 1080p), Component (1080i, 1080p), HDMI (720p, 1080i, 1080p)

DTV (1080i, 1080p), Component (1080i, 1080p), HDMI (720p, 1080i, 1080p)

DTV (1080i, 1080p), Component (1080i, 1080p), HDMI (720p, 1080i, 1080p)

DTV (1080i, 1080p), Component (1080i, 1080p), HDMI (720p, 1080i, 1080p)

DTV (1080i, 1080p), Component (1080i, 1080p), HDMI (720p, 1080i, 1080p)

DTV (1080i, 1080p), Component (1080i, 1080p), HDMI (720p, 1080i, 1080p)

DTV (1080i, 1080p), Component (1080i, 1080p), HDMI (720p, 1080i, 1080p)

DTV (1080i, 1080p), Component (1080i, 1080p), HDMI (720p, 1080i, 1080p)

DTV (1080i, 1080p), Component (1080i, 1080p), HDMI (720p, 1080i, 1080p)

DTV (1080i, 1080p), Component (1080i, 1080p), HDMI (720p, 1080i, 1080p)

DTV (1080i, 1080p), Component (1080i, 1080p), HDMI (720p, 1080i, 1080p)

DTV (1080i, 1080p), Component (1080i, 1080p), HDMI (720p, 1080i, 1080p)

DTV (1080i, 1080p), Component (1080i, 1080p), HDMI (720p, 1080i, 1080p)

DTV (1080i, 1080p), Component (1080i, 1080p), HDMI (720p, 1080i, 1080p)

DTV (1080i, 1080p), Component (1080i, 1080p), HDMI (720p, 1080i, 1080p)

DTV (1080i, 1080p), Component (1080i, 1080p), HDMI (720p, 1080i, 1080p)

DTV (1080i, 1080p), Component (1080i, 1080p), HDMI (720p, 1080i, 1080p)

DTV (1080i, 1080p), Component (1080i, 1080p), HDMI (720p, 1080i, 1080p)

DTV (1080i, 1080p), Component (1080i, 1080p), HDMI (720p, 1080i, 1080p)

DTV (1080i, 1080p), Component (1080i, 1080p), HDMI (720p, 1080i, 1080p)

DTV (1080i, 1080p), Component (1080i, 1080p), HDMI (720p, 1080i, 1080p)

DTV (1080i, 1080p), Component (1080i, 1080p), HDMI (720p, 1080i, 1080p)

DTV (1080i, 1080p), Component (1080i, 1080p), HDMI (720p, 1080i, 1080p)

DTV (1080i, 1080p), Component (1080i, 1080p), HDMI (720p, 1080i, 1080p)

DTV (1080i, 1080p), Component (1080i, 1080p), HDMI (720p, 1080i, 1080p)

DTV (1080i, 1080p), Component (1080i, 1080p), HDMI (720p, 1080i, 1080p)

DTV (1080i, 1080p), Component (1080i, 1080p), HDMI (720p, 1080i, 1080p)

DTV (1080i, 1080p), Component (1080i, 1080p), HDMI (720p, 1080i, 1080p)

DTV (1080i, 1080p), Component (1080i, 1080p), HDMI (720p, 1080i, 1080p)

DTV (1080i, 1080p), Component (1080i, 1080p), HDMI (720p, 1080i, 1080p)

DTV (1080i, 1080p), Component (1080i, 1080p), HDMI (720p, 1080i, 1080p)

DTV (1080i, 1080p), Component (1080i, 1080p), HDMI (720p, 1080i, 1080p)

DTV (1080i, 1080p), Component (1080i, 1080p), HDMI (720p, 1080i, 1080p)

DTV (1080i, 1080p), Component (1080i, 1080p), HDMI (720p, 1080i, 1080p)

DTV (1080i, 1080p), Component (1080i, 1080p), HDMI (720p, 1080i, 1080p)

DTV (1080i, 1080p), Component (1080i, 1080p), HDMI (720p, 1080i, 1080p)

DTV (1080i, 1080p), Component (1080i, 1080p), HDMI (720p, 1080i, 1080p)

DTV (1080i, 1080p), Component (1080i, 1080p), HDMI (720p, 1080i, 1080p)

DTV (1080i, 1080p), Component (1080i, 1080p), HDMI (720p, 1080i, 1080p)

DTV (1080i, 1080p), Component (1080i, 1080p), HDMI (720p, 1080i, 1080p)

DTV (1080i, 1080p), Component (1080i, 1080p), HDMI (720p, 1080i, 1080p)

DTV (1080i, 1080p), Component (1080i, 1080p), HDMI (720p, 1080i, 1080p)

DTV (1080i, 1080p), Component (1080i, 1080p), HDMI (720p, 1080i, 1080p)

DTV (1080i, 1080p), Component (1080i, 1080p), HDMI (720p, 1080i, 1080p)

DTV (1080i, 1080p), Component (1080i, 1080p), HDMI (720p, 1080i, 1080p)

DTV (1080i, 1080p), Component (1080i, 1080p), HDMI (720p, 1080i, 1080p)

DTV (1080i, 1080p), Component (1080i, 1080p), HDMI (720p, 1080i, 1080p)

DTV (1080i, 1080p), Component (1080i, 1080p), HDMI (720p, 1080i, 1080p)

DTV (1080i, 1080p), Component (1080i, 1080p), HDMI (720p, 1080i, 1080p)

DTV (1080i, 1080p), Component (1080i, 1080p), HDMI (720p, 1080i, 1080p)

DTV (1080i, 1080p), Component (1080i, 1080p), HDMI (720p, 1080i, 1080p)

DTV (1080i, 1080p), Component (1080i, 1080p), HDMI (720p, 1080i, 1080p)

DTV (10

- Before connecting your device to the TV, please back up your files to prevent them from damage or loss of data. SAMSUNG is not responsible for any data file damage or data loss.
- A USB device that requires high power (more than 0.5A) may not be supported.
- Do not disconnect the USB device while it is loading.
- The higher the resolution of the image, the longer it takes to display on the screen.
- If a file is corrupted or the TV does not support the file type, the "Not Supported File Format" message appears.
- The TV cannot play MP3 files with DRM that have been downloaded from a for-pay site. Digital Rights Management (DRM) is a technology that supports the creation, distribution, and management of digital content in an integrated and comprehensive way, including protecting the rights and interests of content providers, preventing illegal copying of contents, and managing billing and settlements.
- PTP devices are not supported.
- If an over-power warning message is displayed while you are connecting or using a USB device, the device may not be recognized or may malfunction.
- If the TV has no input during the time period set in **Auto Protection Time**, the Screensaver will run.

Supported Subtitle Formats

External		
Name	File extension	
MPEG-4 timed text	.txt	
SAMI	.srt	
SubRip	.srt	
SubViewer	.sub	
Micro DVD	.sub.or_.txt	
SubStation Alpha	.ssa	
Advanced SubStation Alpha	.ass	
Internal		
Name	Container	Format
Sub	AVI	Picture Format
SubStation Alpha	MKV	Text Format
Advanced SubStation Alpha	MKV	Text Format
SubRip	MKV	Text Format
MPEG-4 Timed text	MP4	Text Format

Supported Video Formats

File Extension	Container	Video Codec	Resolution	Frame rate(fps)	Bit rate(Mbps)	Audio Codec	
*.mp4	MP4	DxK 3.11/4.x/5.1 /G	1920x1080	6-30	30Mbps	MP3 / ADPCM / AAC	
		H264	1920x1080	6-30	30Mbps		
		AVC	1920x1080	6-30	30Mbps		
		MLPEG	640x480	6-30	10Mbps		
*.avi	AVI	DxK 3.11/4.x/5.1 /G	1920x1080	6-30	30Mbps	MP3 / AC3 / LPCM / ADPCM / AAC	
			MPEG4 SP	1920x1080	6-30	30Mbps	
			H264	1920x1080	6-30	30Mbps	
			MLPEG	640x480	6-30	10Mbps	
*.avi	MKV	DxK 3.11/4.x/5.1 /G	1920x1080	6-30	30Mbps	MP3 / AC3 / LPCM / ADPCM / AAC	
			MPEG4 SP	1920x1080	6-30	30Mbps	
			H264	1920x1080	6-30	30Mbps	
			MLPEG	640x480	6-30	10Mbps	
*.avi	ASF	DxK 3.11 / 4.x /5.1 /G	1920x1080	6-30	30Mbps	MP3 / AC3 / LPCM / ADPCM / AAC	
			MPEG4 SP / ASP	1920x1080	6-30	30Mbps	
			H264	1920x1080	6-30	30Mbps	
			MPEG2	1920x1080	6-30	30Mbps	
*.ts	TS	H.264 SP / MP / HP	1920x1080	6-30	30Mbps	AC3 / AAC / MP3 / DDP / HE-AAC	
			MPEG1	1920x1080	24/25/30	30Mbps	AC3 / AAC / LPCM / ADPCM / AAC
*.dat	PS	H.264 SP / MP / HP	1920x1080	6-30	30Mbps	AC3 / AAC / LPCM / ADPCM / AAC	
			MPEG2	1920x1080	6-30	30Mbps	
*.3gp	3GPP	MPEG4 SP / ASP	1920x1080	6-30	30Mbps	MP3	
			H.264	1920x1080	6-30	30Mbps	
*.avi	Flash formats	Sorenson H.263	1920x1080	6-30	30Mbps	MP3	

Videos



- In the **Media Play** menu, press the ◀ or ▶ button to select **Videos**, and then press the ENTER button.
- Press the ◀/▶/▲/▼ buttons to select a video in the file list.
- Press the ENTER button or [] (Play) button.
 - The file name is displayed on the top of the screen with the playing time.
 - If video time information is unknown, playing time and the progress bar are not displayed.
 - During video playback, you can search using the ◀ and ▶ buttons.
- In this mode, you can play movie clips contained in a game, but you cannot play the game itself.

Other Restrictions

- Video content will not play, or not play correctly, if there is error in the content or the container.
- Sound or video may not work if the contents have a standard bit rate/frame rate above the compatible Frame/sec listed in the Supported Video Formats table.
- If the Index Table erroneous, the Seek (Jump) function is not supported.
- The menu may take longer to appear if the video's bit rate exceeds 10Mbps.
- Video content can not be played if there are many contents in one file.

Video Decoder

- Supports up to H.264, Level 4.1
- H.264 FMO / ASO / VCS, RC1 SP / MP / AP L4 and AVCHD are not supported.
- MPEG4 SP ASP :
 - Below 1280 x 720: 60 frame max
 - Above 1280 x 720: 30 frame max
- GMC is not supported.
- H.263 is not supported.
- Supports up to WMA7, 8, 9 STD, 9 PRO, 10 PRO
- WMA 9 PRO and WMA 10 PRO support 5.1 channel. (LBR mode of WMA Pro is not supported)
- WMA Lossless is not supported.

Audio Decoder

- Supports up to DTS, 5.1
- Supports up to WMA7, 8, 9 STD, 9 PRO, 10 PRO
- WMA 9 PRO and WMA 10 PRO support 5.1 channel. (LBR mode of WMA Pro is not supported)
- WMA Lossless is not supported.

Music

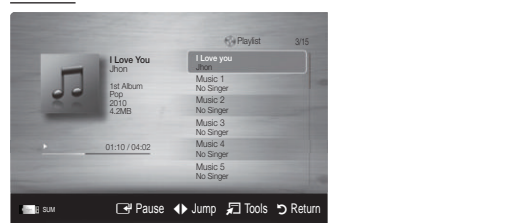

- In the **Media Play** menu, press the ◀ or ▶ button to select **Music**, and then press the ENTER button.
- Press the ◀/▶/▲/▼ buttons to select the desired Music in the file list.
 - During music playback, you can search using the ◀ and ▶ button.
 - [] (REW) and [] (FF) buttons do not function during play.
- Media Play only displays files with MP3 and PCM file extension. Other file extensions are not displayed, even if they are saved on the same USB device.
 - If the sound is abnormal when playing MP3 files, adjust the **Equalizer** in the **Sound** menu. (An over-modulated MP3 file may cause a sound problem.)

Photos

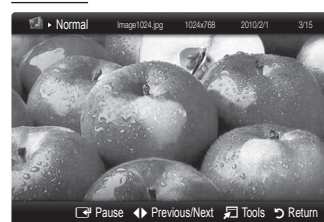

- In the **Media Play** menu, press the ◀ or ▶ button to select **Photos**, then press the ENTER button.
- Press the ◀/▶/▲/▼ buttons to select a photo in the file list.
- Press the ENTER button or [] (Play) button.
 - NOTE
 - While a photo list is displayed, press the [] (Play) / ENTER button on the remote control to start a slide show.
 - All files in the file list section will be displayed in the slide show.
 - During the slide show, files are displayed in order.
 - During the slide show, you can adjust the slide show speed using [] (REW) or [] (FF) button.
 - Media Play** can play Music files automatically during a Slide Show if **Background Music** is set to **On**.
 - You cannot change the **Mode** in **Background Music** until the **Background Music** file has finished loading.
- Supported Photo Formats

Image	Photo	Resolution
JPEG	Base-line	15360 x 8704
	Progressive	1024 x 768

Other Restrictions

- CMYK, YOCK Color space JPEG are not supported.

Playing Multiple Files

- Playing selected video/music/photo files
 - On the File List screen, highlight a file, and then press the Yellow button on your remote.
 - Repeat Step 1 to select multiple files.
 - NOTE
 - A ✓ mark appears to the left of the selected files.
 - To cancel a selection, press the Yellow button again.
 - To deselect all selected files, press the TOOLS button, select **Deselect All**, and then the ENTER button.
- Press the TOOLS button, select **Play Selected Contents**, and then press the ENTER button.
- Playing a video/music/photo folder
 - With the folders on your USB device displayed, use the ◀/▶/▲/▼ buttons to highlight a folder.
 - Press the TOOLS button, select **Play Folder**, and then press the ENTER button.

Media Play - Additional Functions

Videos/Music/Photos Play Option menus

Category	Operation	Videos	Music	Photos
Title	You can select another video file to play directly.			
Repeat Mode	You can play movie and music files repeatedly.	✓	✓	
Picture Size	You can adjust the picture size to your preference.	✓		
Picture Mode	You can adjust the picture setting.	✓		✓
Auto Motion Plus	You can enhance motion in fast moving scenes.	✓		
Sound Mode	You can adjust the sound setting.	✓	✓	
Subtitle Setting	You can play the video with Subtitles. This function only works if the subtitles have the same file name as the video.	✓		
Audio Format	You can select the digital audio output format.	✓		
Audio Language	You can change the audio language if the video has more than one language.	✓		
Stop Slide Show / Start Slide Show	You can start or stop a Slide Show.	✓		
Slide Show Speed	You can select the slide show speed during the slide show.	✓		
Background Music	You can set and select background music when watching a Slide Show.	✓		
Zoom	You can zoom into images in full screen mode.	✓		
Rotate	You can rotate images in full screen mode.	✓		
Information	You can see detailed information about the played file.	✓	✓	✓

NOTE

- Standard dimensions for wall mount kits are shown in the table below.
- When purchasing our wall mount kit, a detailed installation manual and all parts necessary for assembly are provided.
- Do not use screws that do not comply with the VESA standard screw specifications.
- Do not use screws that are longer than the standard dimension or do not comply with the VESA standard screw specifications. Screws that are too long may cause damage to the inside of the TV set.
- For wall mounts that do not comply with the VESA standard screw specifications, the length of the screws may differ depending on the wall mount specifications.
- Do not fasten the screws too firmly. This may damage the product or cause the product to fall, leading to personal injury. Samsung is not liable for these kinds of accidents.
- Samsung is not liable for product damage or personal injury when a non-VESA or non-specified wall mount is used or the consumer fails to follow the product installation instructions.
- Do not mount the TV at more than a 15 degree tilt.
- Always have two people mount the TV on a wall.

Product Family	TV size in inches	VESA screw hole specs (A * B) in millimeters	Standard Screw	Quantity
LED-TV	19~22	75 X 75	M4	4
	26	100 X 100		
	32~40	200 X 200	M6	
	46~60	400 X 400	M8	



Securing the TV to the Wall

- Caution: Pulling, pushing, or climbing onto the TV may cause the TV to fall. In particular, ensure that your children do not hang over or destabilize the TV, doing so may cause the TV to tip over, resulting in serious injuries or death. Follow all safety precautions provided on the included Safety Flyer. For added stability, install the anti-fall device for safety purposes, as follows.

To prevent the TV from falling

- Since the necessary brackets, screws, and string or cable are not supplied, please purchase these separately.
- Insert the screws into the wall brackets and firmly fasten them to the wall. Make sure the screws are firmly fixed to the wall. We strongly recommend you drive the screws into a stud.
- Using screws, insert the screws through the TV brackets, and then fasten the screws to the top VESA screw holes on the back of the TV.
- Connect the brackets on the TV and the brackets on the wall with a strong string or cable, and then tie the string or cable tightly to the brackets.
- Verify all connections are properly secured. Periodically check the connections for any sign of fatigue or failure. If you have any doubt about the security of your connections, contact a professional installer.
- Install the TV close to the wall so that it does not fall.
- Connect the string or cable so that the brackets on the wall are at the same height or lower than the brackets on the TV. Untie the string or cable before moving the TV.
- To purchase a TV Holder kit, contact Samsung customer care.

Storage and Maintenance

- If a sticker was attached to the TV screen, some debris can remain after you remove the sticker. Please clean it before watching the TV.
- The exterior and screen of the product can get scratched during cleaning. Be sure to wipe the exterior and screen carefully using a soft cloth to prevent scratches.

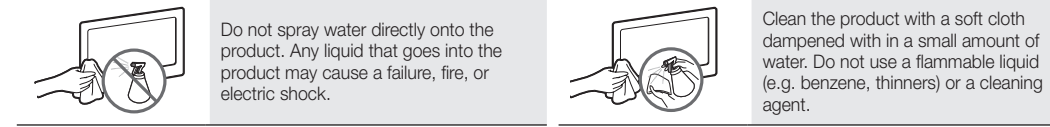

License

SRS THEATERSOUND

TheaterSound, SRS and the symbol are trademarks of SRS Labs, Inc. TheaterSound technology is incorporated under license from SRS Labs, Inc.

DIXX HD

DixX Certified® to play DixX® video up to HD 1080p, including premium content.

ABOUT DIXX VIDEO: DixX® is a digital video format created by DixX, LLC, a subsidiary of RovI Corporation. This is an official DixX Certified® device that plays DixX video. Visit dixx.com for more information and software tools to convert your files into DixX videos. ABOUT DIXX VIDEO-ON-DEMAND: This DixX Certified® device must be registered in order to play purchased DixX Video-on-Demand (VOD) movies. To obtain your registration code, locate the DixX VOD section in your device setup menu. Go to vod.dixx.com for more information on how to complete your registration. Covered by one or more of the following U.S. patents: 7,295,673; 7,469,658; 7,515,710; 7,519,274 DixX®, DixX Certified® and associated logos are trademarks of RovI Corporation or its subsidiaries and are used under license.

DOLBY DIGITAL PLUS

Manufactured under license from Dolby Laboratories. Dolby and the double-D symbol are trademarks of Dolby Laboratories.

dts 2.0 Channel

Manufactured under license under U.S. Patent Nos. 5,956,674; 5,974,380; 6,487,535 & other U.S. and worldwide patents issued & pending. DTS, the Symbol, & DTS and the Symbol together are registered trademarks & DTS 2.0 Channel is a trademark of DTS, Inc. Product includes software. © DTS, Inc. All Rights Reserved.

HDMI

The terms HDMI and HDMI High-Definition Multimedia Interface, and the HDMI Logo are trademarks or registered trademarks of HDMI Licensing LLC in the United States and other countries.

Open Source License Notice
Open Source used in this product can be found on the following webpage. (http://opensource.samsung.com) Open Source License Notice is written only English.

To send inquiries and requests for questions regarding open sources, contact Samsung via the link: opensource@samsung.com.

This product uses some software programs which are distributed under the Independent JPEG Group.
IOU License - IOU 1.8.1 and later
COPYRIGHT AND PERMISSION NOTICE
Copyright (c) 1995-2008 International Business Machines Corporation and others All rights reserved.
Permission is hereby granted, free of charge, to any person obtaining a copy of this software and associated documentation files (the "Software"), to deal in the Software without restriction, including without limitation the rights to use, copy, modify, merge, publish, distribute, and/or sell copies of the Software, and to permit persons to whom the Software is furnished to do so, provided that the above copyright notice(s) and this permission notice appear in all copies of the Software and that both the above copyright notice(s) and this permission notice appear in supporting documentation.
THE SOFTWARE IS PROVIDED "AS IS", WITHOUT WARRANTY OF ANY KIND, EXPRESS OR IMPLIED, INCLUDING BUT NOT LIMITED TO THE WARRANTIES OF MERCHANTABILITY, FITNESS FOR A PARTICULAR PURPOSE AND NONINFRINGEMENT OF THIRD PARTY RIGHTS. IN NO EVENT SHALL THE COPYRIGHT HOLDER OR HOLDERS INCLUDED IN THIS NOTICE BE LIABLE FOR ANY CLAIM, OR ANY SPECIAL, INDIRECT OR CONSEQUENTIAL DAMAGES, OR ANY DAMAGES WHATSOEVER RESULTING FROM LOSS OF USE, DATA OR PROFITS, WHETHER IN AN ACTION OF CONTRACT, NEGLIGENCE OR OTHER TORTIOUS ACTION, ARISING OUT OF OR IN CONNECTION WITH THE USE OR PERFORMANCE OF THIS SOFTWARE.
Except as contained in this notice, the name of a copyright holder shall not be used in advertising or otherwise to promote the sale, use or other dealings in this Software without prior written authorization of the copyright holder.
All trademarks and registered trademarks mentioned herein are the property of their respective owners.

Kensington Lock

The Kensington Lock is not supplied by Samsung. It is a device used to physically fix the system when using it in a public place. Refer to the manual provided with the Kensington Lock for additional information on proper use.

- Please find a "K" icon on the rear of the TV. The Kensington slot is beside the "K" icon.
- The position and color may differ depending on the model.

Assembling the Cable manager

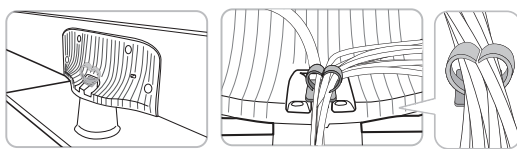

Troubleshooting

If the TV seems to have a problem, first review this list of possible problems and solution. If none of these troubleshooting tips apply, visit samsung.com, then click on Support, or call Samsung customer service at 1-800-SAMSUNG.

Problem	Possible Solution
Flickering and Dimming	If your Samsung Television is flickering or dimming sporadically, you may need to disable some of its energy efficient features like the Energy Saving feature. Follow the steps below with your remote to turn these features off or on. <ul style="list-style-type: none"> Energy saving - Menu → Setup → Eco Solution → Energy Saving → Select Settings
Component Connections / Screen Color	If you find that the color on your Samsung television's screen is not correct or black and white, first run a Self Diagnosis Test on the TV to make sure there are no device issues. <ul style="list-style-type: none"> Self Diagnosis - User Menu → Support → Self Diagnosis → Picture Test If the test is ok, try making sure: <ul style="list-style-type: none"> Your connections are all consistent. For example, if you've used the AV In jack on your TV, make sure you have used the AV Out jack on your video source. Try making sure you have connected to the correct jacks. For example, if you use the Component jacks, labeled Pb, Pr, and Y, to connect your TV and video source, make sure you have connected the blue Pb jack on the video source to the blue Pb jack on the TV, the red Pr jack on the source to the red Pr jack on the TV.
Screen Brightness	If you find that the colors on your Samsung TV are correct but just a little too dark or bright, there are some settings you should check before calling for a repair. <ul style="list-style-type: none"> Backlight, Contrast, Brightness, Sharpness, Color, Tint and so on. Go to "Picture" in the Menu, and then try adjusting these options.
Unwanted Powering off	If your Samsung TV appears to turn off by itself, there may be an issue with either your Timer settings or your Eco friendly No Signal Power Off feature. <p>First make sure the Sleep Timer is not accidentally set. The Sleep Timer lets you fall asleep with the TV still on knowing that it will turn off after a certain period of time and not waste energy.</p> <ul style="list-style-type: none"> Sleep Timer - User Menu → Setup → Time → Sleep Timer If the Sleep Timer is not activated, you may have engaged the No Signal Power Off or Auto Power Off feature. No Signal Power Off - User Menu → Setup → Eco Solution → No Signal Power Off Auto Power Off - User Menu → Setup → Eco Solution → Auto Power Off
Trouble Powering On	Before you turn the TV on, find the red light on the right or left bottom of your TV. Press the power on button on the TV or remote and the light should blink about 5 times before the TV turns on. <p>If you find that you are having trouble powering on your Samsung television, there are a number of things to check it before making a call to the service department.</p> <ul style="list-style-type: none"> If you happen to be using the TV as a monitor and the stand-by light only blinks for a few seconds when you press the power button, your PC is in sleep mode. To take your PC out of sleep mode, press a key on your keyboard or move the mouse. Then try turning your TV on. If you're sure your power cord, remote control, and PC are functioning properly, you may be having a cable issue. If you have a cable or satellite box, your TV may appear to be off because the cable or satellite box is not outputting a signal. To test the signal output of your cable or satellite box, press the guide or info button on the cable or satellite box remote control. If the screen displays the guide or info data, the problem is caused by the box.

Specifications

Model Name	UN55FH6003	UN60FH6003	UN65FH6001
Display Resolution	1920 x 1080		
Screen Size (Diagonal)	55" Class (54.6" measured diagonally)	60" Class (60.0" measured diagonally)	65" Class (64.5" measured diagonally)
Sound Output	10W x 2		
Dimensions(W x H x D)			
Body	49.2 X 28.9 X 3.7 inches (1250.6 X 736.7 X 94.3 mm)	54.1 X 31.4 X 3.7 inches (1376.6 X 799.3 X 94.4 mm)	58.4 X 34.4 X 3.7 inches (1484.5 X 873.8 X 95.3 mm)
With stand	49.2 X 31.0 X 8.9 inches (1250.6 X 789.2 X 227.6 mm)	54.1 X 33.9 X 12.9 inches (1376.5 X 862.5 X 329.7 mm)	58.4 X 36.4 X 12.9 inches (1484.5 X 926.5 X 329.8 mm)
Weight Without Stand	38.8 lbs (17.6 kg)	49.8 lbs (22.6 kg)	63.0 lbs (28.6 kg)
With Stand	44.7 lbs (20.3 kg)	59.0 lbs (26.8 kg)	72.3 lbs (32.8 kg)

- Design and specifications are subject to change without prior notice.
- This device is a Class B digital apparatus.
- For information about power supply, and more about power consumption, refer to the label attached to the product.
- Typical power consumption is measured according to Energy Star Program requirements for Televisions.
- Dispose unwanted electronics through an approved recycler. To find the nearest recycling location, go to our website: www.samsung.com/recyclingdirect or call, (877) 278-0799.

JACK PANEL DETAIL / REAR VIEW

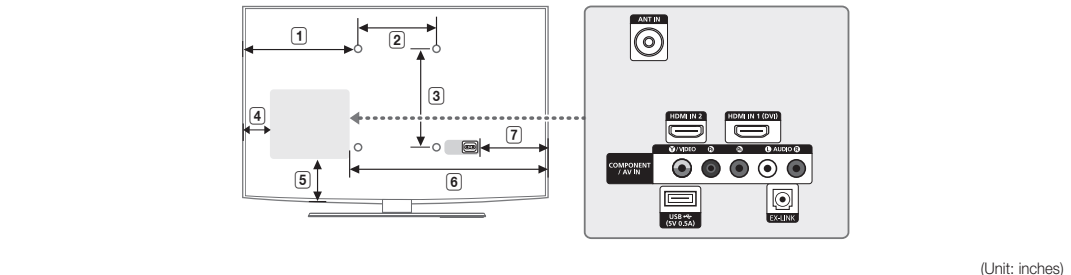

Model name	①	②	③	④	⑤	⑥	⑦
UN55FH6003	16.7	15.7	15.7	6.1	7.5	36.4	12.6
UN60FH6003	19.1	15.7	15.7	8.6	9.2	38.8	14.9
UN65FH6001	21.3	15.7	15.7	10.7	9.5	41.0	17.2

NOTE: All drawings are not necessarily to scale. Some dimensions are subject to change without prior notice. Refer to the dimensions prior to performing installation of your TV. Not responsible for typographical or printed errors.
© 2013 Samsung Electronics America, Inc